

CLASS 1 ENCLOSURES FOR KEYENCE LASER MARKERS

REV 3-26

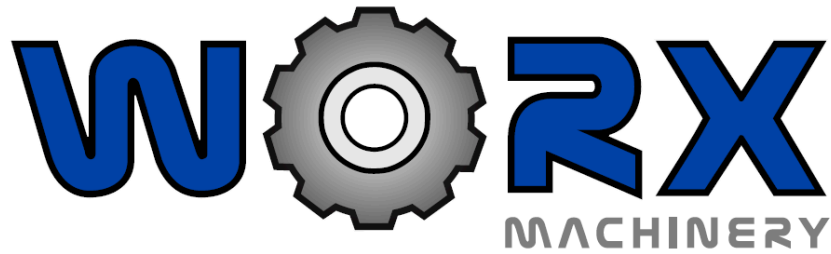

4960 Marsett PKWY, Suite B
Cumming, GA 30041
Phone: 678-878-6772
Email: john_hanks@worxmachinery.com
website: worxmachinery.com

TABLE OF CONTENTS

About Us	3
Machine Comparison Guide	4
ME-4_D	6
ME-4_V	10
ME-2_M	16
ME-2	23
ME-2_X	30
ME-3_M	37
ME-3	48
ME-3_R	59
ME-3_{MAX}	64
Contact Us	74

ABOUT US

Worx Machinery was established in 2008. The owner, John Hanks, has over 25 years of automation background and has assembled a top notch team of automation engineers and technicians. For the first 5 years, Worx specialized in automated assembly and inspection cells. These cells included machine vision, robots, barcode reading, laser measurement, etc. As laser marking started to appear on the industrial automation scene, Worx partnered with KEYENCE to develop an entire line of Class 1 laser marking enclosures to compliment the exceptional KEYENCE laser marking line. Over the past 12 years, Worx has developed and refined the enclosure offering to what is now nine standard enclosures of varying levels of capability. Worx also excels in full custom enclosure design. Worx and KEYENCE's dedication to quality, service, and technology has produced the best laser marking solutions in the industry.

Manual Enclosure Quick Reference Guide

	ME-4d	ME-4v	ME-2m	ME-2	ME-2x
Door Style	Drawer Style	Manual Vertical	Swinging	Swinging	Dual Swinging
Mobile base	N/A	Optional	Optional	Optional	Optional
Fume Extractor	Optional	Optional	Optional	Optional	Optional
PC Package	Optional	Optional	Optional	Optional	Optional
Pass Through	N/A	N/A	Optional	Optional	Optional
Manual Shelf	N/A	Standard	Standard	Standard	Standard
Grid Plate	150x150	300x300	300x300	450x450	450x900
MDU2	Standard Area only	Standard or Wide Area	Standard or Wide Area	Standard or Wide Area	Standard or Wide Area
MDF	N/A	Standard or Wide Area	Standard or Wide Area	Standard or Wide Area	Standard or Wide Area
MDX2	Standard Area only	Standard or Wide Area	Standard or Wide Area	Standard or Wide Area	Standard or Wide Area
MLZ	N/A	Standard or Wide Area	Standard or Wide Area	Standard or Wide Area	Standard or Wide Area

Automated Enclosure Quick Reference Guide

	ME-3	ME-3m	ME-3max	ME-3r
Z Actuator Stroke	400mm	Optional Auto Z Shelf (150mm)	400mm	400mm
X Actuator Stroke	N/A	N/A	500mm	N/A
Y Actuator Stroke	N/A	N/A	350mm	N/A
Door Style	Automated Vertical	Automated Vertical	Automated Vertical	2 Position Rotary Table
Mobile Base	Optional	Optional	Included	Included
Slide Out Shelf	Optional	N/A	Optional	N/A
Fume Extractor	Optional	Optional	Optional	Optional
PC Package	Included	Included	Included	Included
Pass Through	Optional	Optional	Optional	N/A
Rotary Indexer	Optional	Optional	Optional	Optional
Tapped Hole Grid Plate	450x450	300x300	600x900	300x300 (Included)
MDU2	Standard or Wide Area	Standard or Wide Area	Standard or Wide Area	Standard or Wide Area
MDF	Standard or Wide Area	Standard or Wide Area	Standard or Wide Area	Standard or Wide Area
MDX2	Standard or Wide Area	Standard or Wide Area	Standard or Wide Area	Standard or Wide Area
MLZ	Standard or Wide Area	Standard or Wide Area	Standard or Wide Area	Standard or Wide Area
Barcode Scanner Package	Optional	Optional	Optional	Optional

ME-4d Laser Marking Enclosure

\$7495.00

- Class 1 certified for use with KEYENCE lasers (MD-X2 and MD-U2 standard area lasers only)
- Laser head is fix mounted on top of enclosure
- Drawer with tapped hole grid plate for small parts only
- 2" fume extraction port on the back of the enclosure

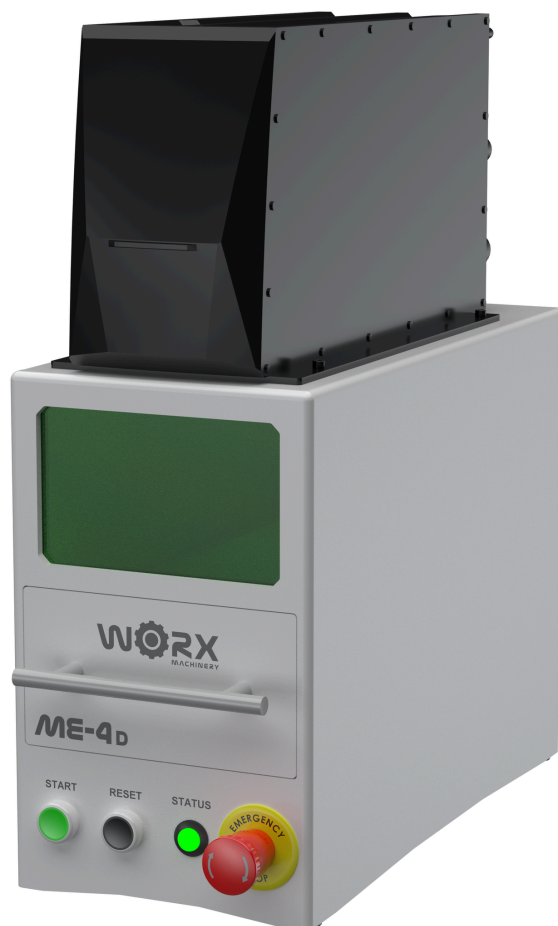

ME-4b Options

FA1M Fume Extractor \$2895.00

- 165 CFM
- HEPA Filtration @ 0.3 micron



PC (No Arm) \$2495.00

- PC with Windows 11 Pro/
monitor/keyboard/wireless mouse



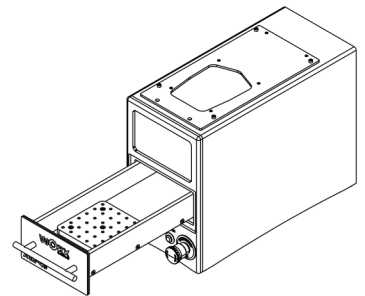
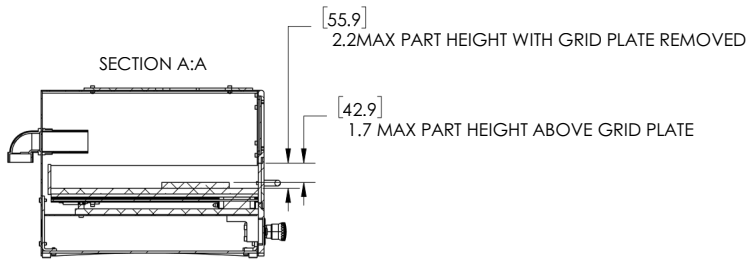

GRID PLATE FOR FIXTURE MOUNTING - M6 X 1.0 TAPPED HOLES ON 25MM CENTERS

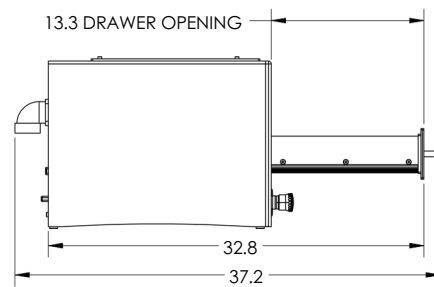
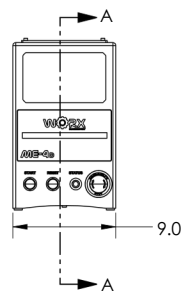
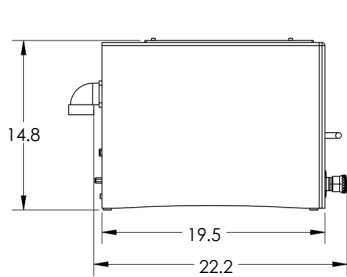
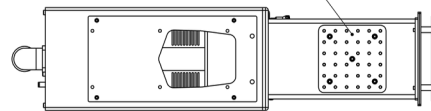
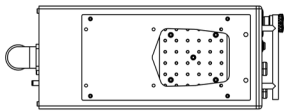

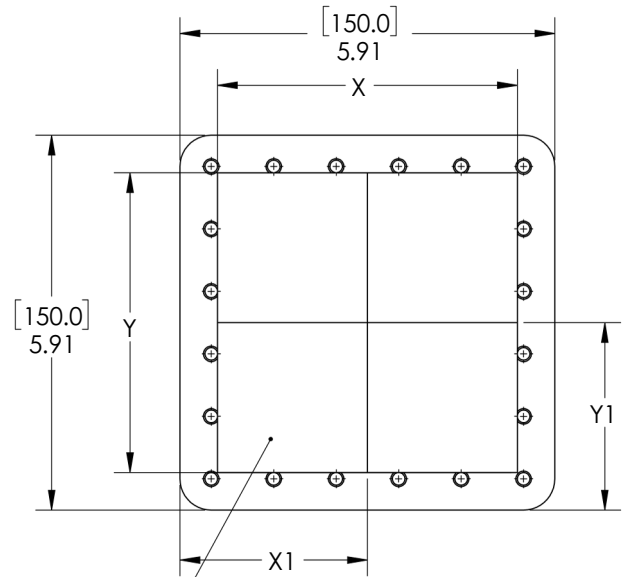
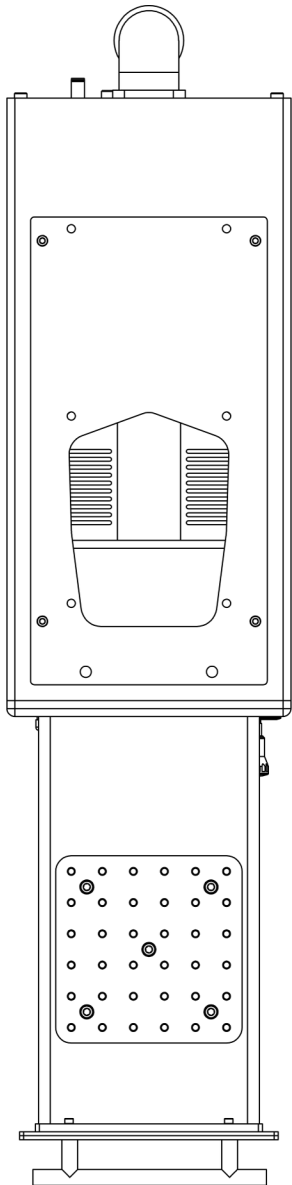

LASER MARKING AREA

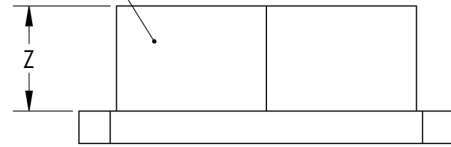

Laser Model	X	Y	X1	Y1	Z
STANDARD AREA MD-X2	125	125	82	75	41
STANDARD AREA MD-U2	125	125	75	75	41

ME-4v Laser Marking Enclosure

\$12895.00

- Class 1 certified for use with KEYENCE lasers (ML-Z, MD-X2, MD-U2, and MD-F, both standard and wide area variants)
- Laser head is fix mounted inside the enclosure
- Vertical door with safety switches wired to the laser shutter control circuit
- Reposition-able shelf to accommodate small/large parts
- Tapped hole grid plate work surface (M6x1 tapped holes on 25mm centers)
- 2" fume extraction port



ME-4v Options

FA1M Fume Extractor \$2895.00

- 165 CFM
- HEPA Filtration @ 0.3 micron



ME-4v Open Mobile Base \$3895.00

- Aluminum extrusion frame
- Leveling casters
- Bottom shelf for laser controller and fume extractor storage

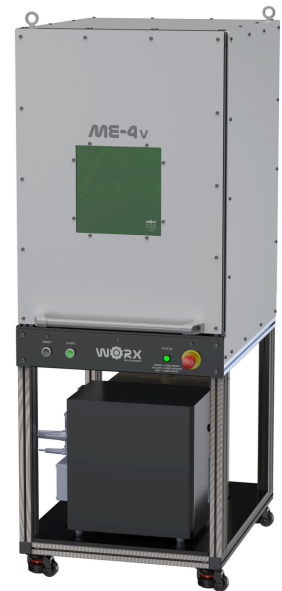

PC (No Arm) \$2495.00

- PC with Windows 11 Pro
/monitor/keyboard/wireless mouse



ME-4v Options

PC/Arm Package (Only available with open mobile base option) \$3995.00

- PC with Windows 11 Pro /monitor/keyboard/wireless mouse on an articulating arm



Fixturing Kit \$895.00

- 1 ea corner datum
- 2 ea vee blocks
- 4 ea round blocks
- 4 ea round eccentric blocks



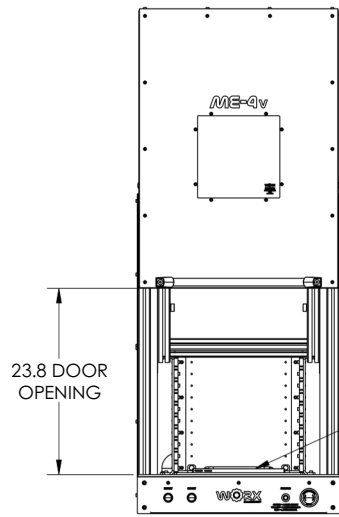
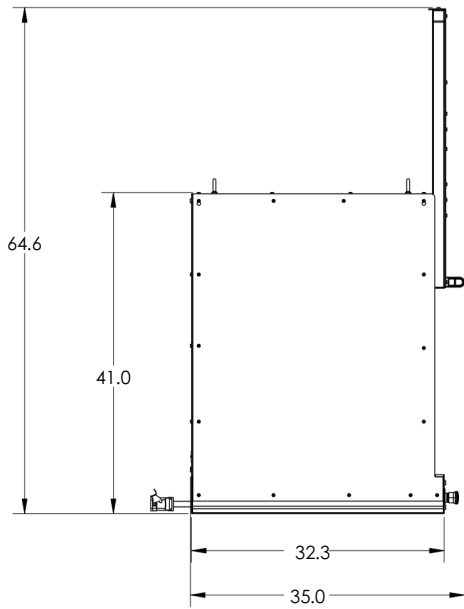
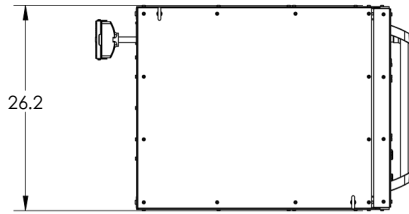

SHELF ELEVATION IS
ADJUSTABLE IN 10x 1.5"
INCREMENTS

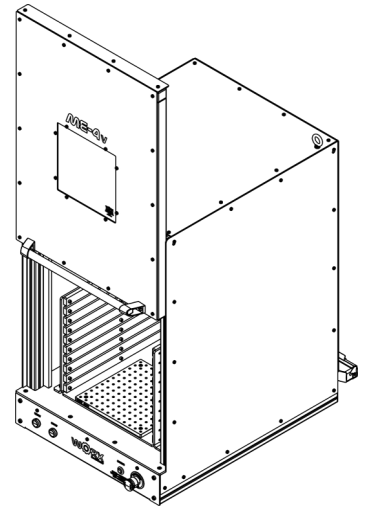

ME-4v Open Mobile Base Dimensions Page 14

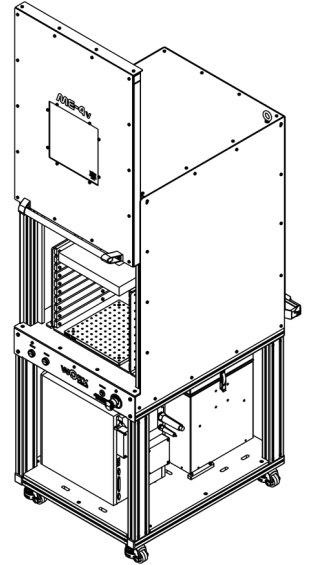
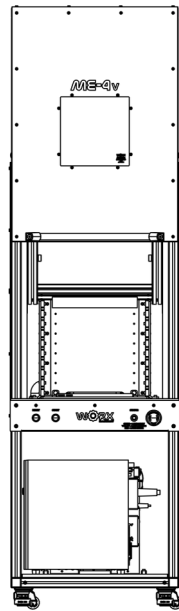
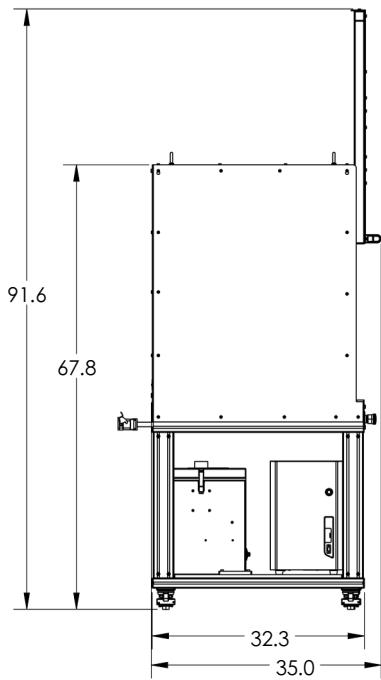
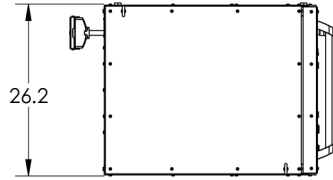

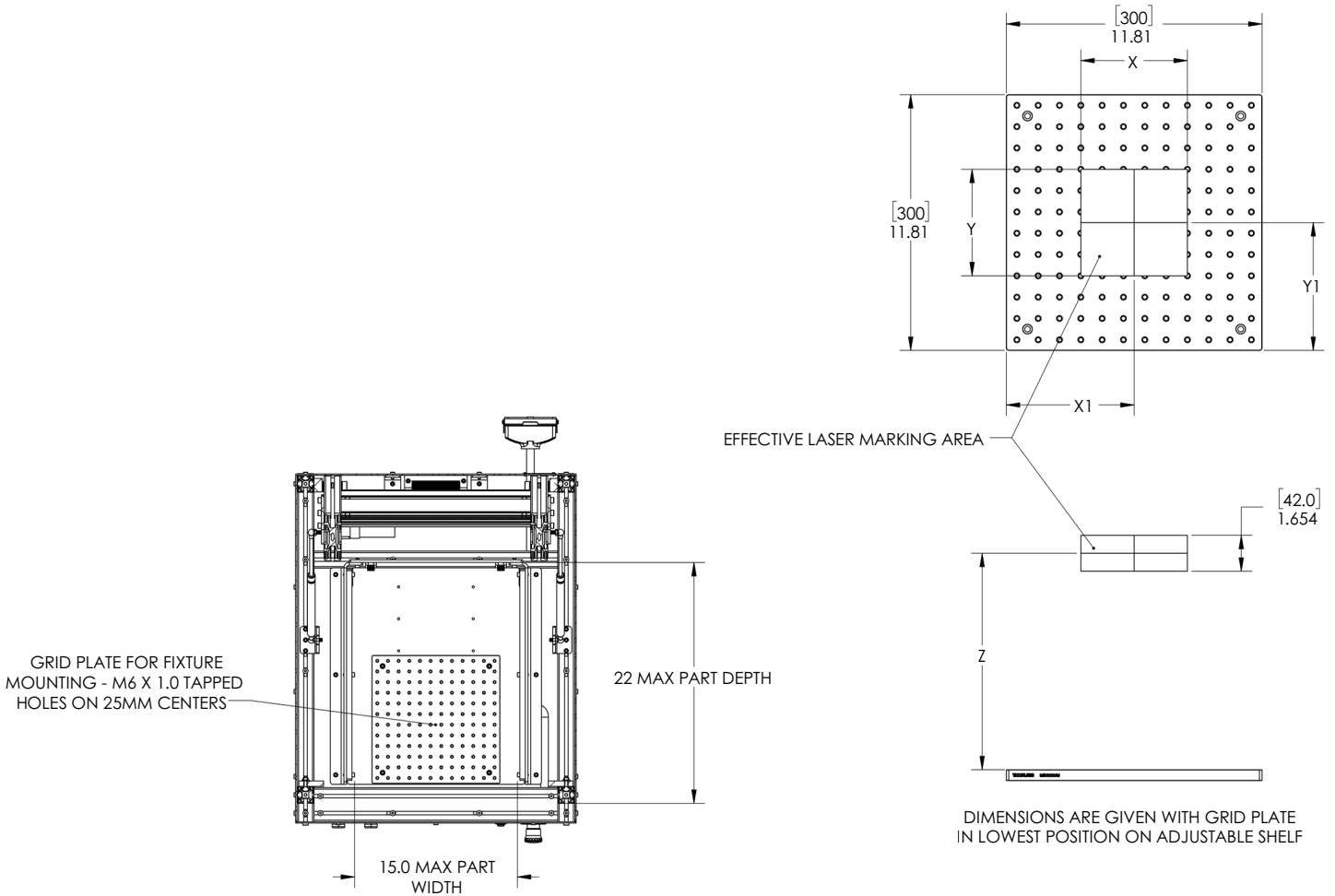

Laser Model	X	Y	X1	Y1	Z
STANDARD AREA MD-X2	125	125	157	150	352
WIDE AREA MD-X2	330	330	157	150	352
STANDARD AREA MD-U2	125	125	150	175	302
WIDE AREA MD-U2	330	330	150	175	302
STANDARD AREA ML-Z	120	120	157	150	352
WIDE AREA ML-Z	300	300	157	150	352
STANDARD AREA MD-F	125	125	150	150	373
WIDE AREA MD-F	300	300	150	150	352

NOTE: ADD 6.35MM (.25") TO ALL Z DIMENSIONS IF PLACING GRID PLATE DIRECTLY ON FLOOR OF ME-4v

ME-Z_M Laser Marking Enclosure **\$9595.00**

- Class 1 certified for use with KEYENCE lasers (ML-Z, MD-X2, MD-U2, and MD-F, both standard and wide area variants)
- Laser Head is fix mounted on top of the enclosure
- Manual swing out door with safety switches wired to the laser shutter control circuit
- Reposition-able shelf to accommodate small/large parts
- Tapped hole grid plate work surface (M6x1 tapped holes on 25mm centers)
- 2" fume extraction port

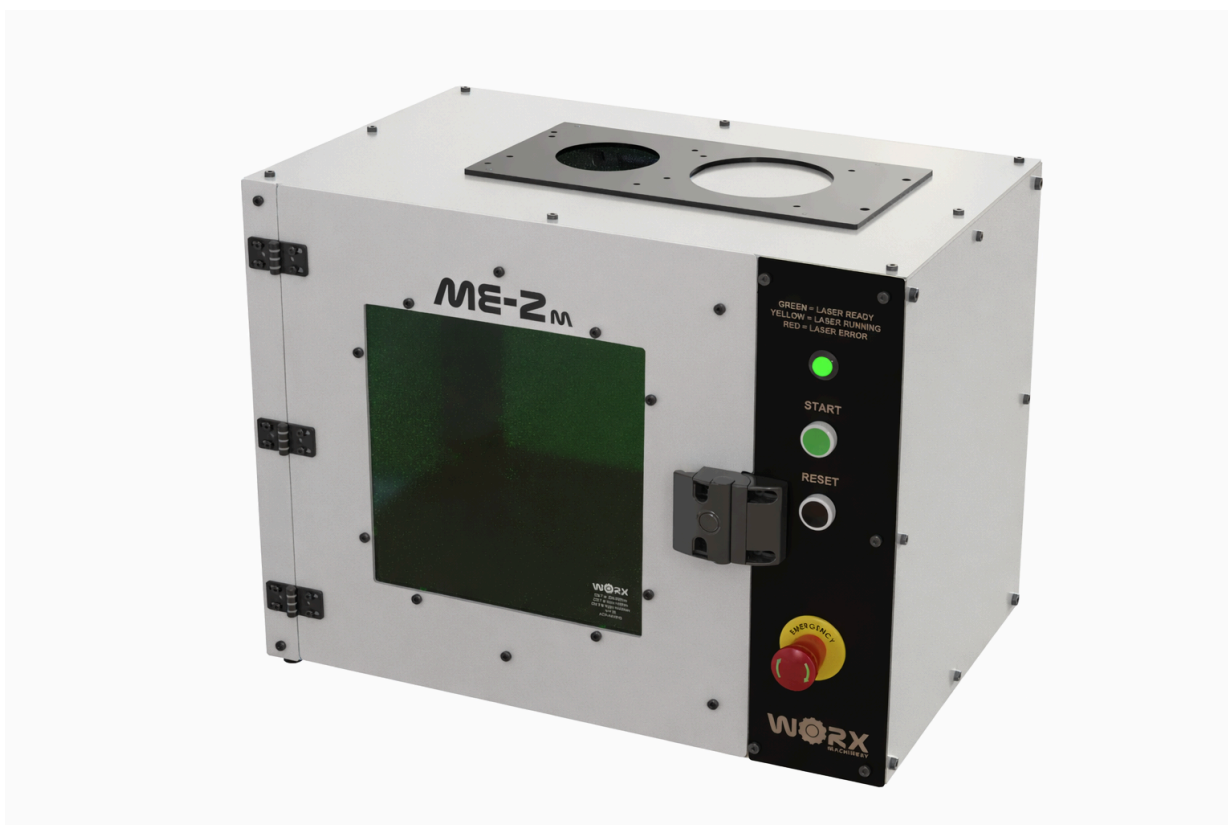

ME-2_M Options

FA1M Fume Extractor \$2895.00

- 165 CFM
- HEPA Filtration @ 0.3 micron



ME-2/ME-2_M Open Mobile Base \$4595.00

- Aluminum extrusion frame
- Leveling casters
- Bottom shelf for laser controller and fume extractor storage

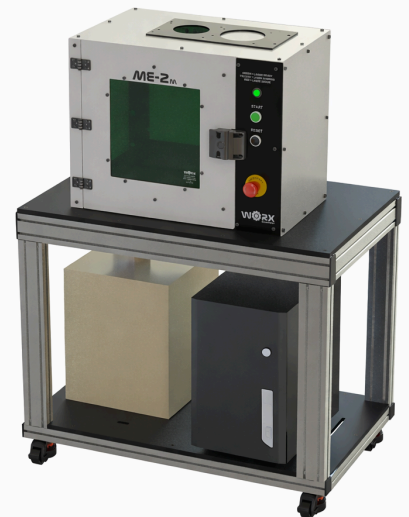

Long Part Pass Through Hole Port \$2495.00

- Round nylon bristle pass through hole
- Must submit drawing of part to Worx for approval/record
- 2.5" OD max

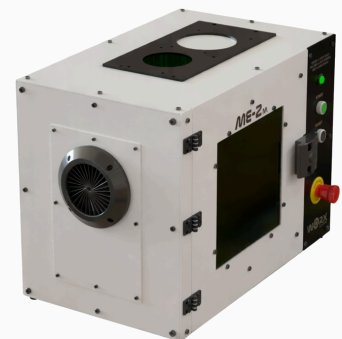

ME-2_M Options

PC (No Arm) \$2495.00

- PC with Windows 11 Pro
/monitor/keyboard/wireless mouse



PC/Arm Package (Only available with Open Mobile Base Option) \$3995.00

- PC with Windows 11 Pro
/monitor/keyboard/wireless mouse on an articulating arm



Fixturing Kit \$895.00

- 1 ea corner datum
- 2 ea vee blocks
- 4 ea round blocks
- 4 ea round eccentric blocks



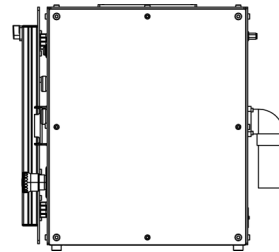
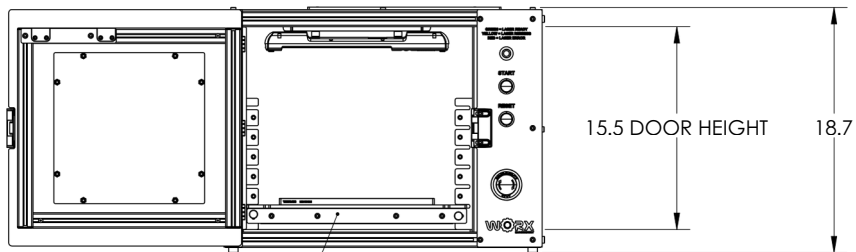
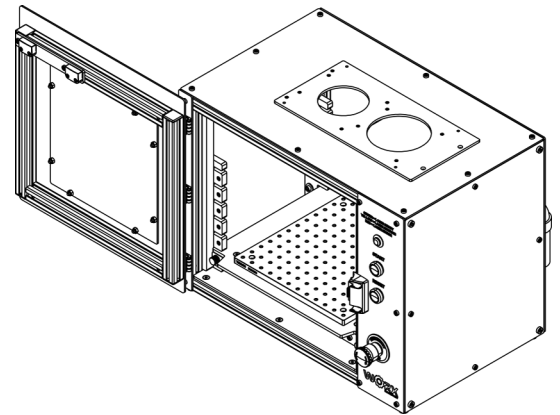
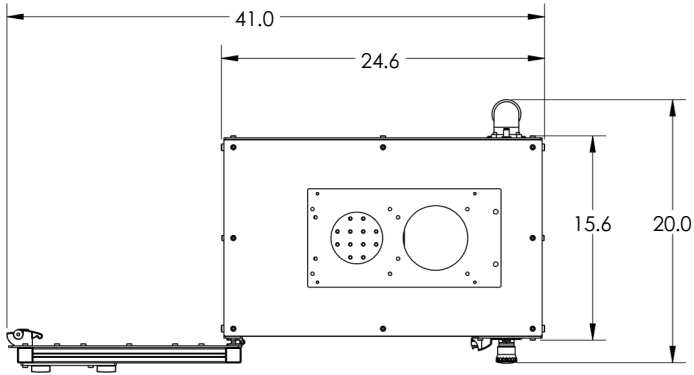

SHELF ELEVATION IS
ADJUSTABLE IN 6x 1.5"
INCREMENTS

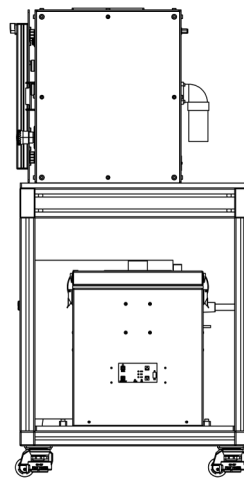
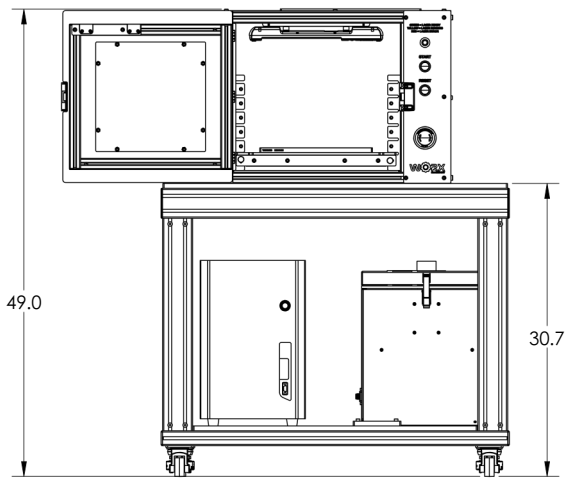
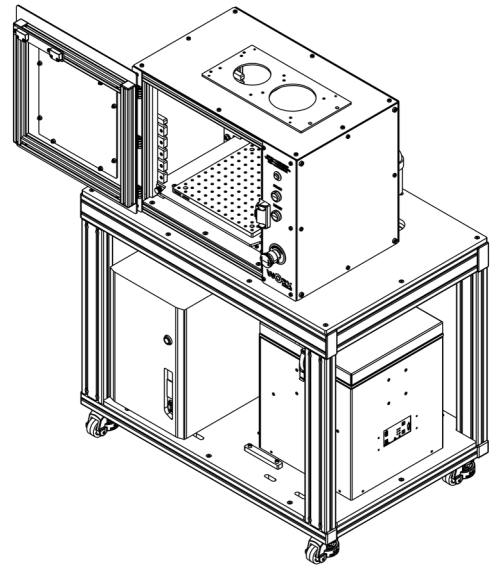
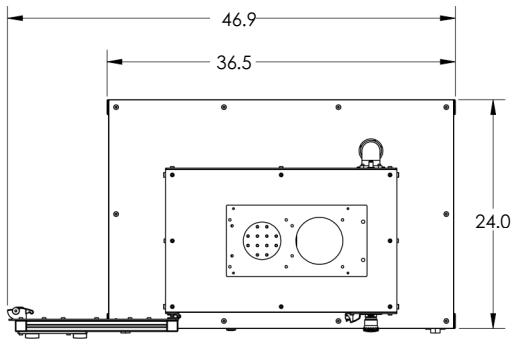

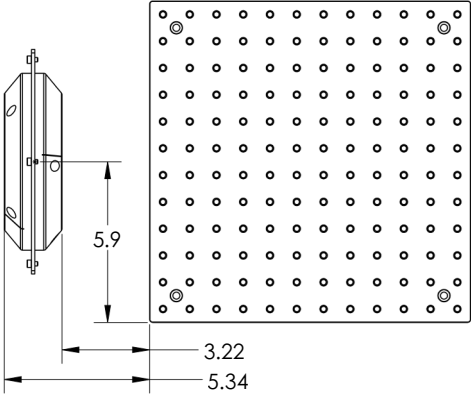

PASS THROUGH PANEL CAN BE
FLIPPED TO PUT CENTER OF HOLE
AT TWO DIFFERENT HEIGHTS

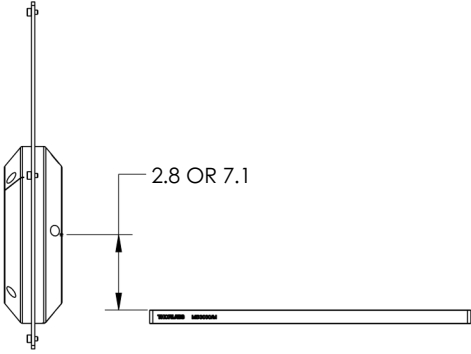
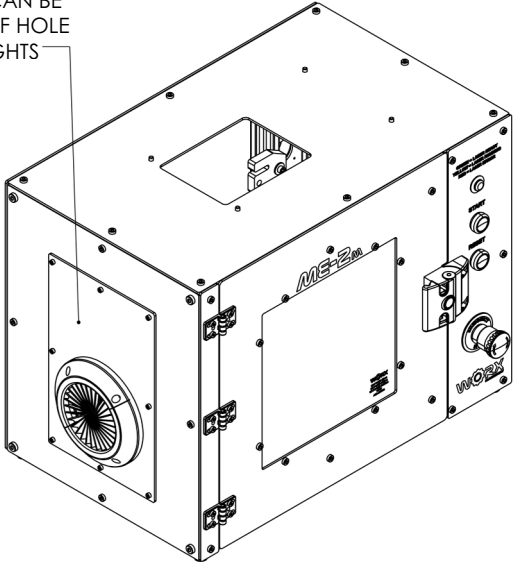

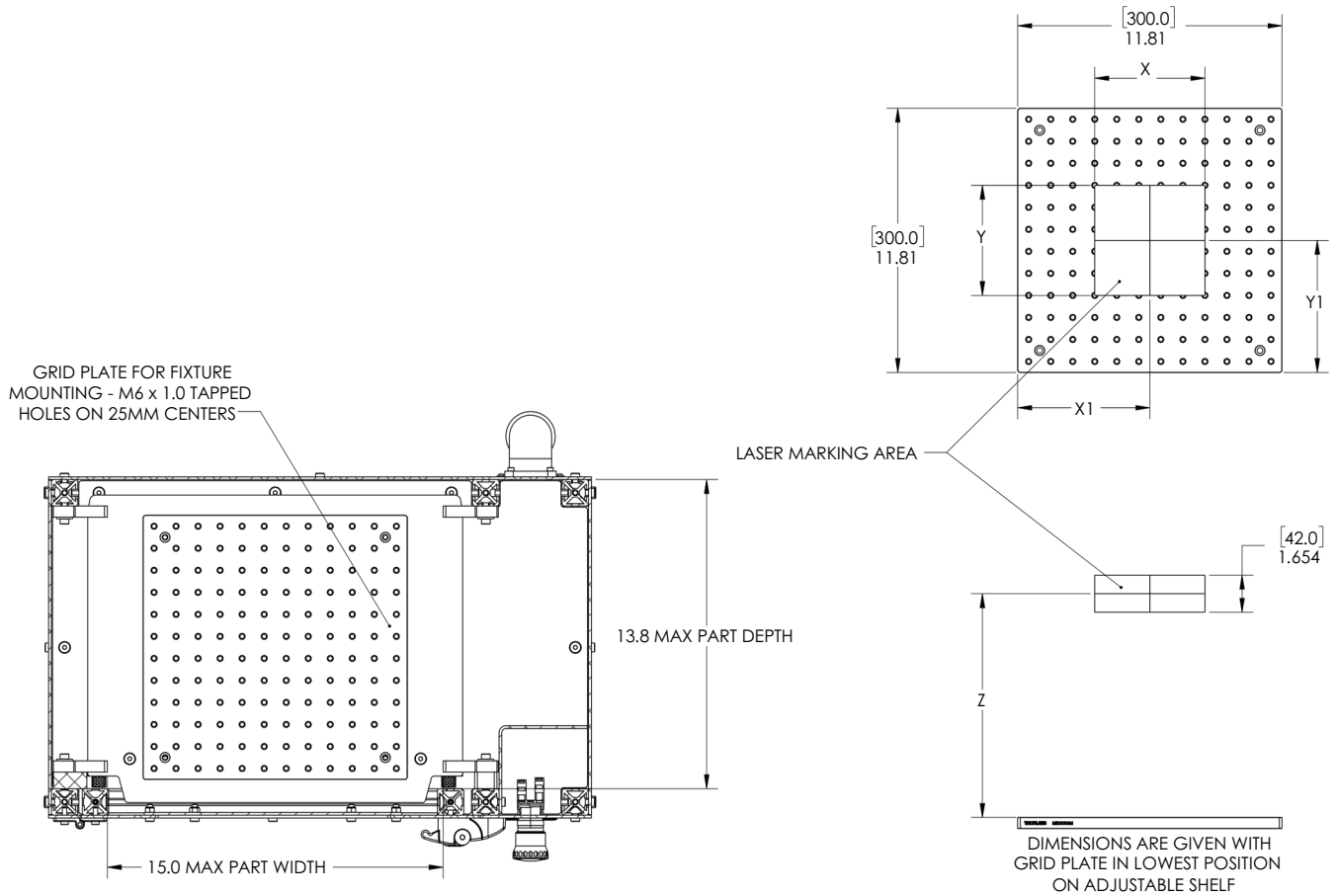

Laser Model	X	Y	X1	Y1	Z
WIDE AREA MD-U1, MD-X1, MD-X2	330	330	150	143	70
STANDARD AREA MD-U1, MD-X1, MD-X2	125	125	150	143	181
WIDE AREA MD-U2	330	330	150	150	70
STANDARD AREA MD-U2	125	125	150	150	181
WIDE AREA ML-Z	300	300	150	143	70
STANDARD AREA ML-Z	120	120	150	143	181
WIDE AREA MD-F	300	300	150	150	70
STANDARD AREA MD-F	125	125	150	150	202

NOTE: ADD 47MM (1.875") TO ALL Z DIMENSIONS IF PLACING GRID PLATE DIRECTLY ON THE FLOOR OF ME-2M

ME-2 Laser Marking Enclosure

\$10595.00

- Class 1 certified for use with KEYENCE lasers (ML-Z, MD-X2, MD-U2, and MD-F, both standard and wide area variants)
- Laser head is fix mounted on top of the enclosure
- Manual swing out door with safety switches wired to the laser shutter control circuit
- Reposition-able shelf to accommodate for small/large parts
- Tapped hole grid plate work surface (M6x1 tapped holes on 25mm centers)
- 2" fume extraction port

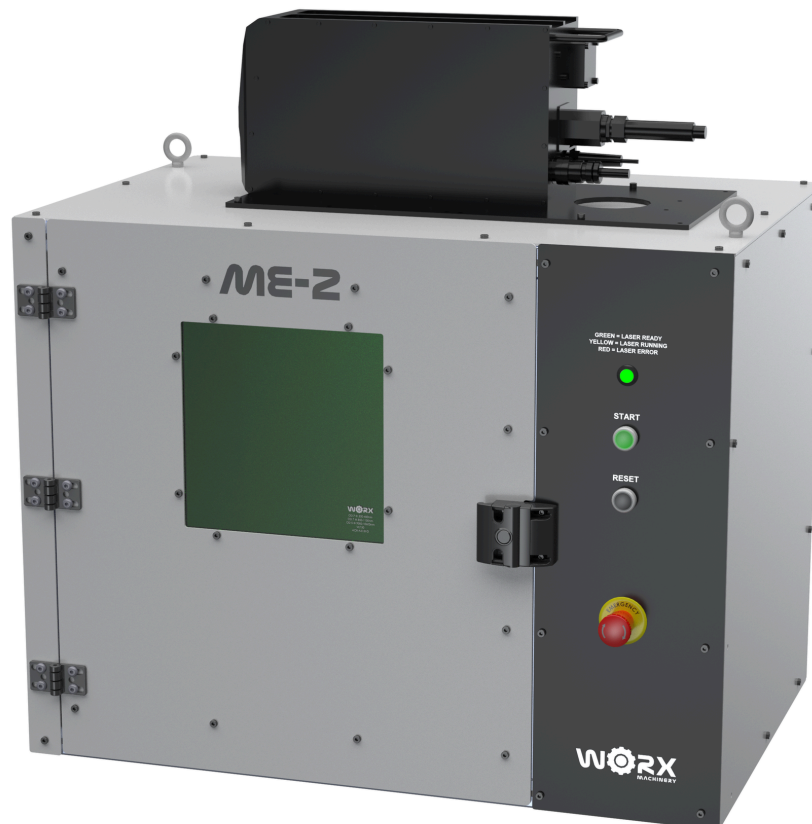

ME-2 Options

FA1M Fume Extractor \$2895.00

- 165 CFM
- HEPA Filtration @ 0.3 micron



ME-2/ME-2_M Open Mobile Base \$4595.00

- Aluminum extrusion frame
- Leveling casters
- Bottom shelf for laser controller and fume extractor storage

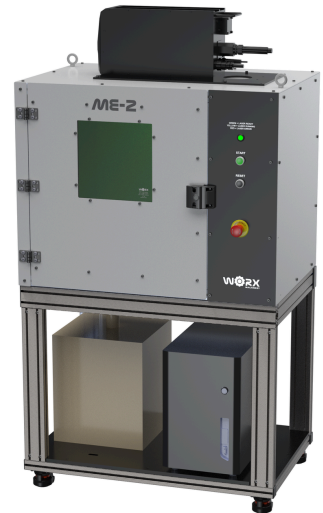

Long Part Pass Through Hole Port \$2495.00

- Round nylon bristle pass through hole
- Must submit drawing of part to Worx for approval/record
- 2.5" OD max



ME-2 Options

PC (No Arm) \$2495.00

- PC with Windows 11 Pro
/monitor/keyboard/wireless mouse



PC/Arm Package (Only available with Open Mobile Base Option) \$3995.00

- PC with Windows 11 Pro
/monitor/keyboard/wireless mouse on an articulating arm



Fixturing Kit \$895.00

- 1 ea corner datum
- 2 ea vee blocks
- 4 ea round blocks
- 4 ea round eccentric blocks



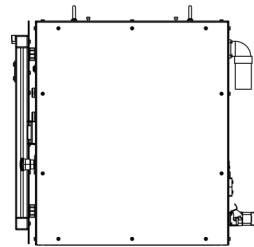
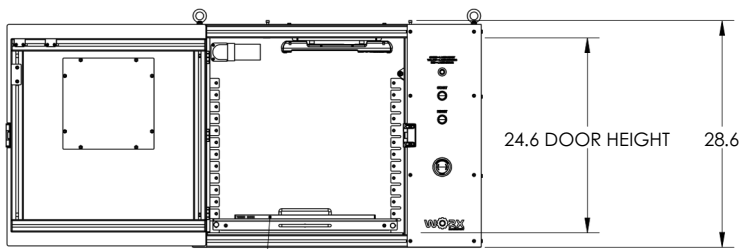
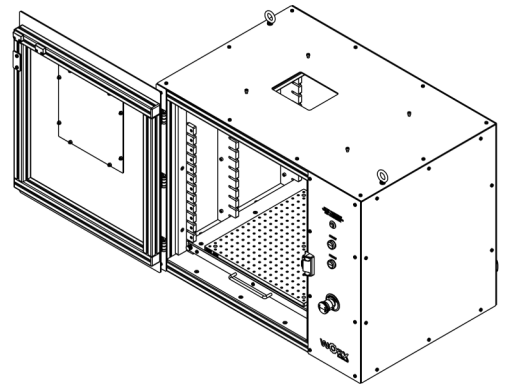
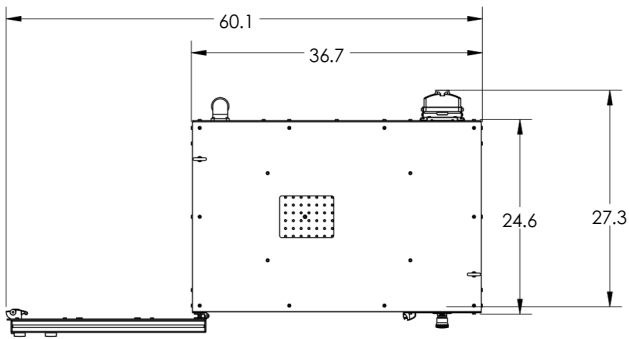

SHELF ELEVATION IS
ADJUSTABLE IN 13x 1.5"
INCREMENTS

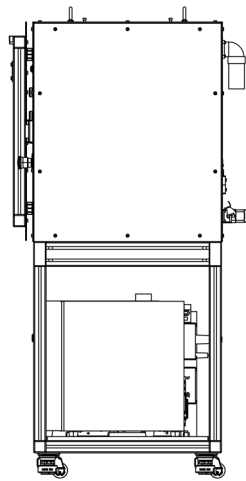
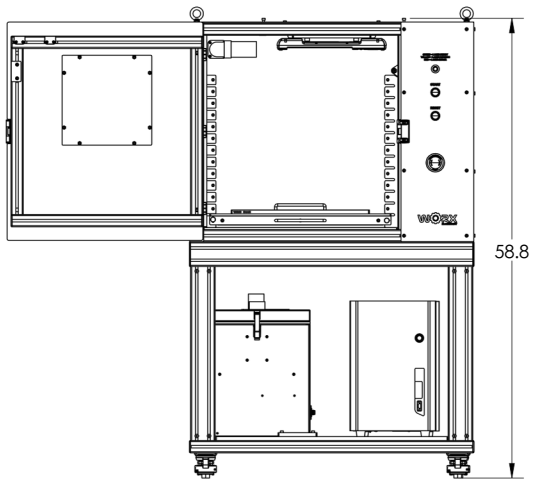
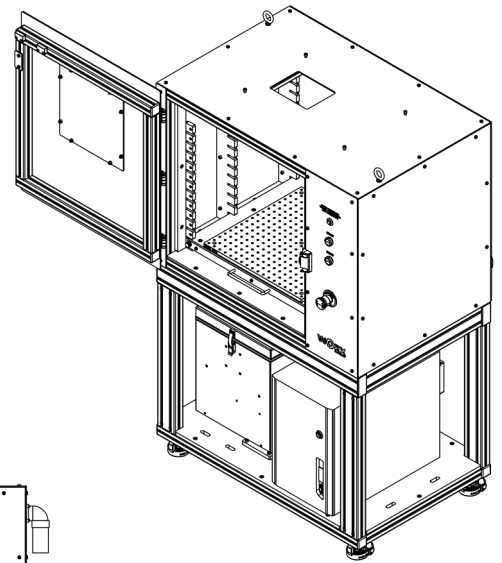
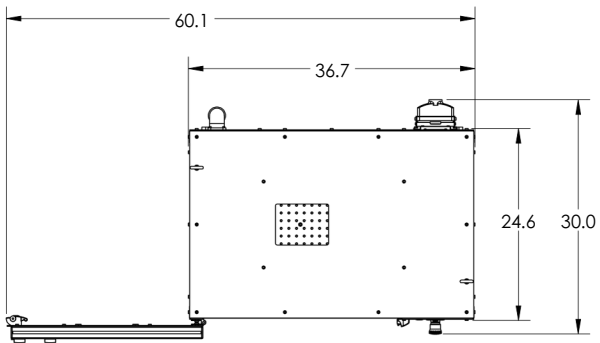

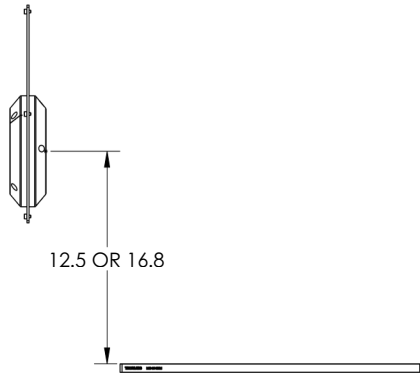
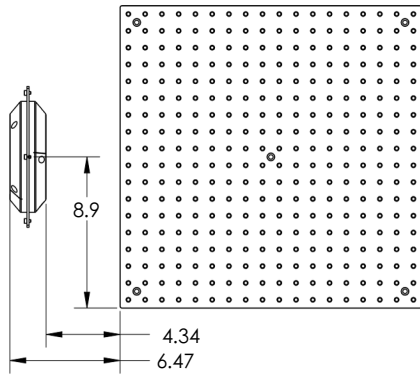

PASS THROUGH PANEL CAN BE FLIPPED TO PUT CENTER OF HOLE AT TWO DIFFERENT HEIGHTS

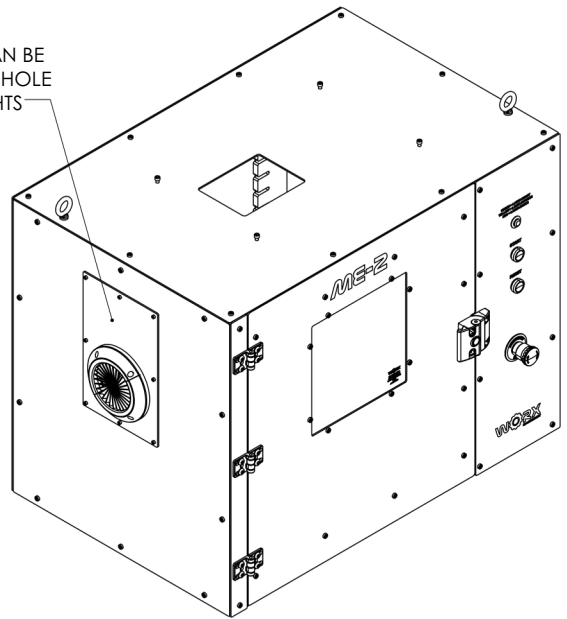

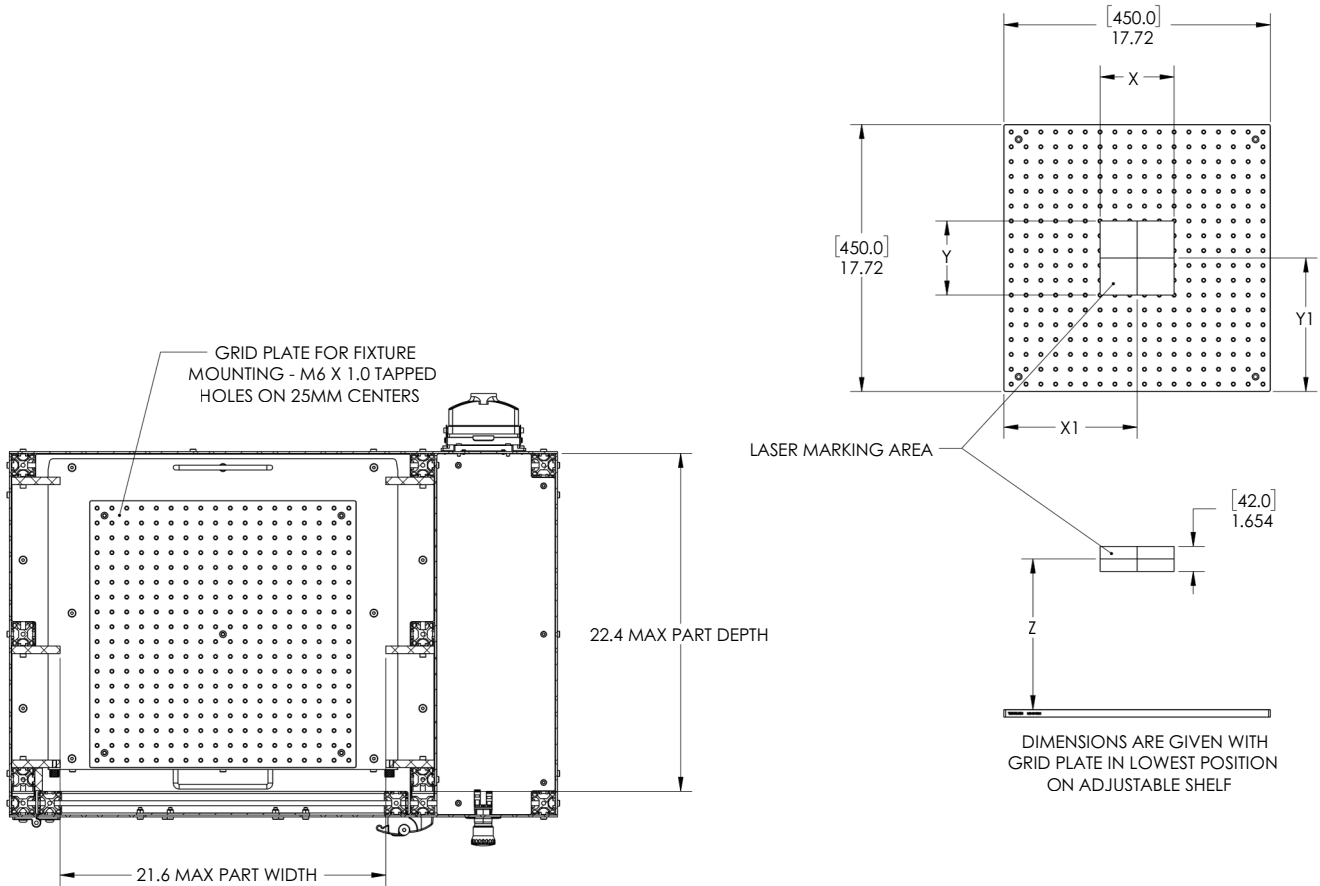

Laser Model	X	Y	X1	Y1	Z
WIDE AREA MD-U1, MD-X1, MD-X2	330	330	225	218	317
STANDARD AREA MD-U1, MD-X1, MD-X2	125	125	225	218	428
WIDE AREA MD-U2	330	330	225	225	317
STANDARD AREA MD-U2	125	125	225	225	428
WIDE AREA ML-Z	300	300	225	218	317
STANDARD AREA ML-Z	120	120	225	218	428
WIDE AREA MD-F	300	300	225	225	317
STANDARD AREA MD-F	125	125	225	225	449

NOTE: ADD 44MM (1.75") TO ALL Z DIMENSIONS IF PLACING GRID PLATE DIRECTLY ON FLOOR OF ME-2

ME-2_x Laser Marking Enclosure

\$13595.00

- Class 1 certified for use with KEYENCE lasers (ML-Z, MD-X2, MD-U2, and MD-F, both standard and wide area variants)
- Laser head is fix mounted on top of the enclosure
- Manual swing out doors with safety switches wired to the laser shutter control circuit
- Reposition-able shelf to accommodate for small/large parts
- Tapped hole grid plate work surface (M6x1 tapped holes on 25mm centers)
- 2" fume extraction port



ME-2x Options

FA1M Fume Extractor \$2895.00

- 165 CFM
- HEPA Filtration @ 0.3 micron



ME-2x Open Mobile Base \$5895.00

- Aluminum extrusion frame
- Leveling casters
- Bottom shelf for laser controller and fume extractor storage

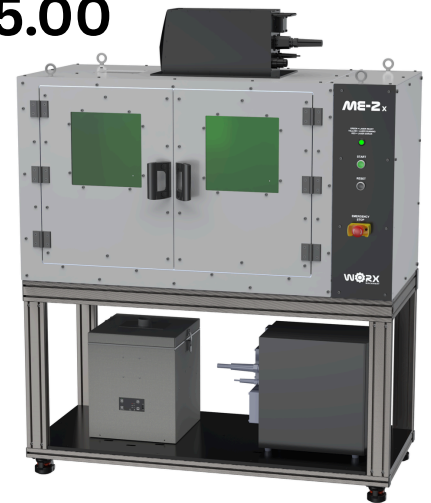

Long Part Pass Through Hole Port \$2495.00

- Round nylon bristle pass through hole
- Must submit drawing of part to Worx for approval/record
- 2.5" OD max

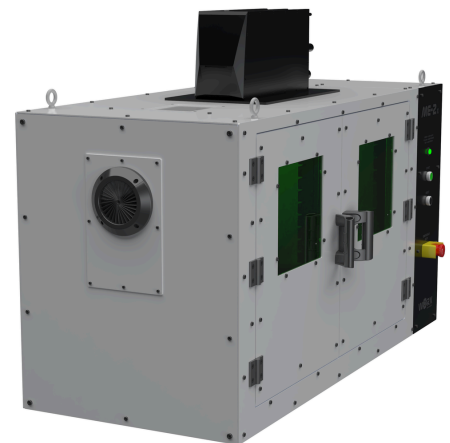

ME-2x Options

PC (No Arm) \$2495.00

- PC with Windows 11 Pro
/monitor/keyboard/wireless mouse



PC/Arm Package (Only available with Open Mobile Base Option) \$3995.00

- PC with Windows 11 Pro
/monitor/keyboard/wireless mouse on an articulating arm



Fixturing Kit \$895.00

- 1 ea corner datum
- 2 ea vee blocks
- 4 ea round blocks
- 4 ea round eccentric blocks



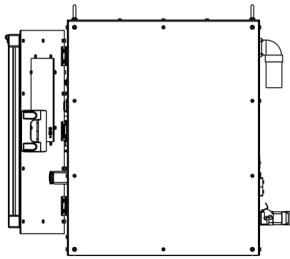
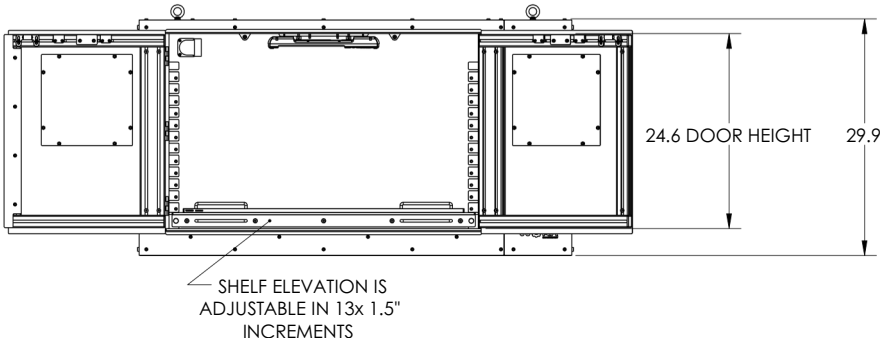
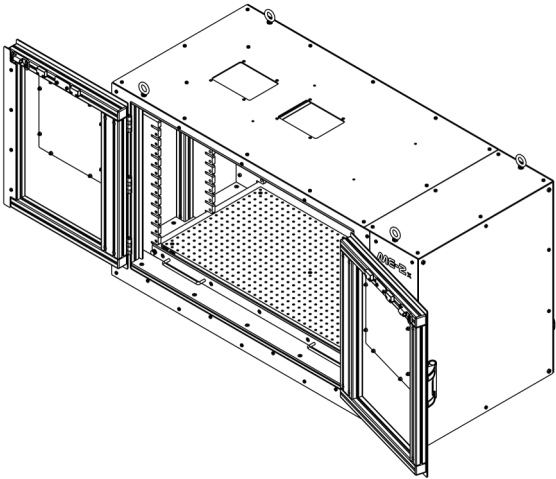
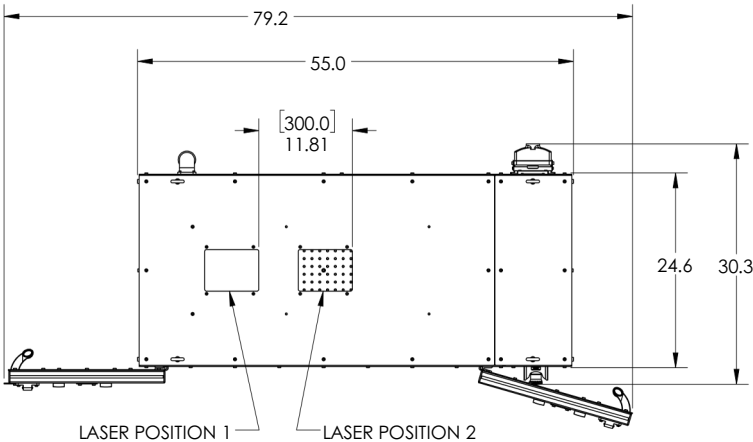

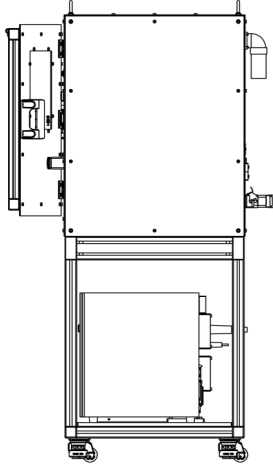
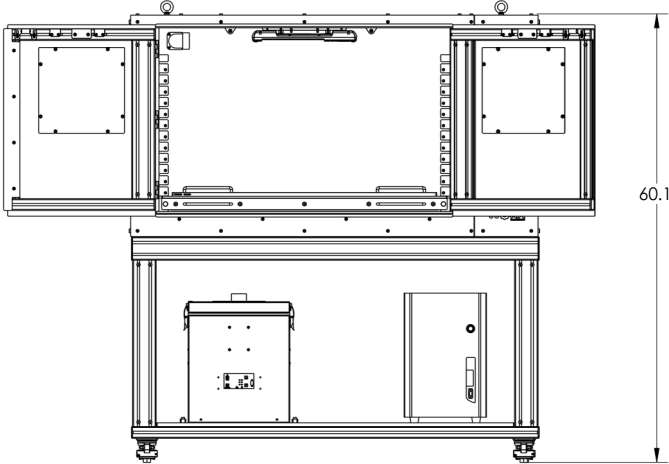
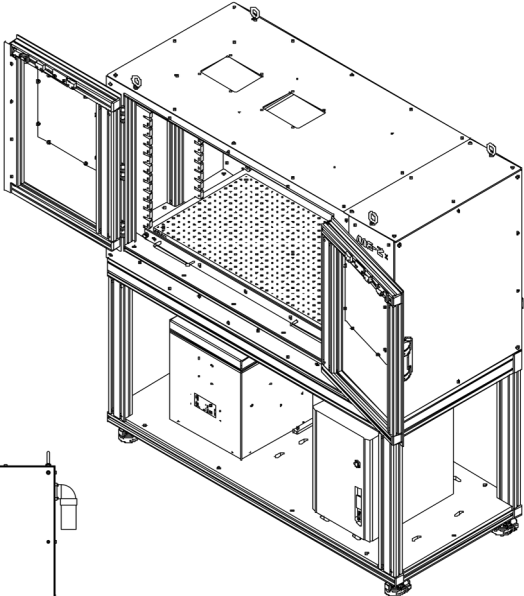
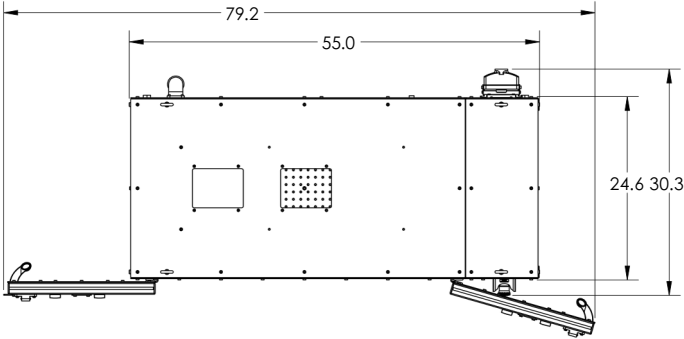

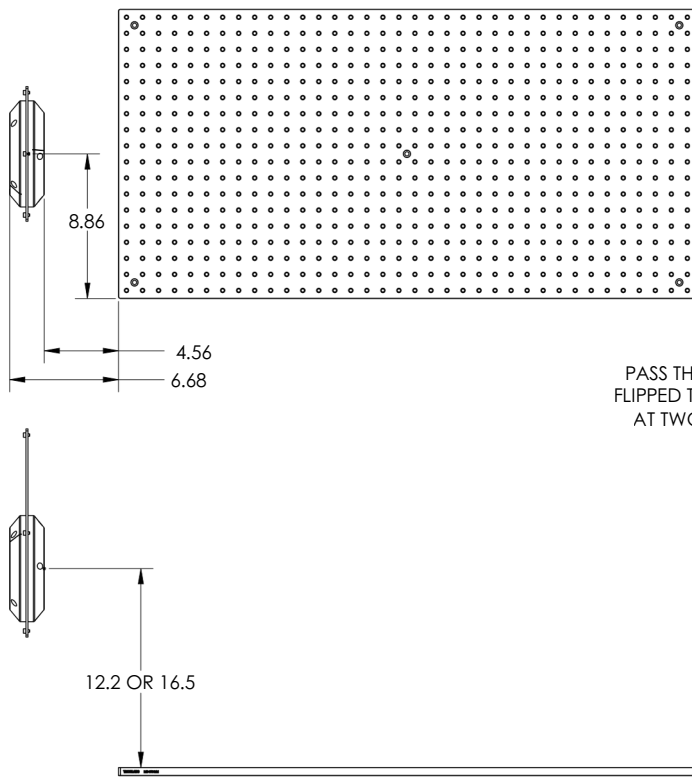

PASS THROUGH PANEL CAN BE
FLIPPED TO PUT CENTER OF HOLE
AT TWO DIFFERENT HEIGHTS

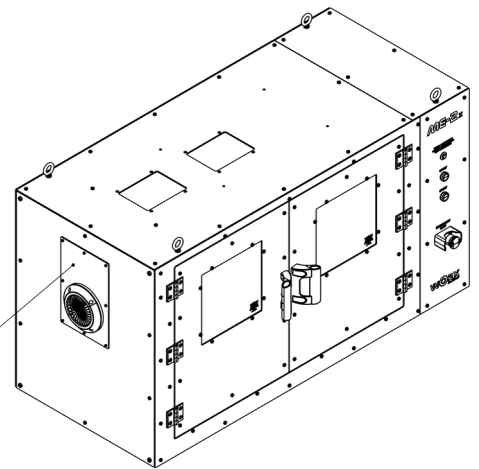

GRID PLATE FOR FIXTURE MOUNTING - M6x1.0 TAPPED HOLES ON 25MM CENTERS

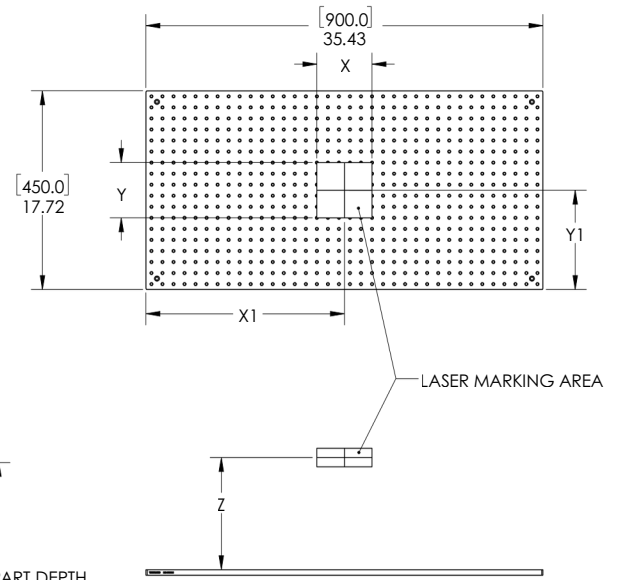
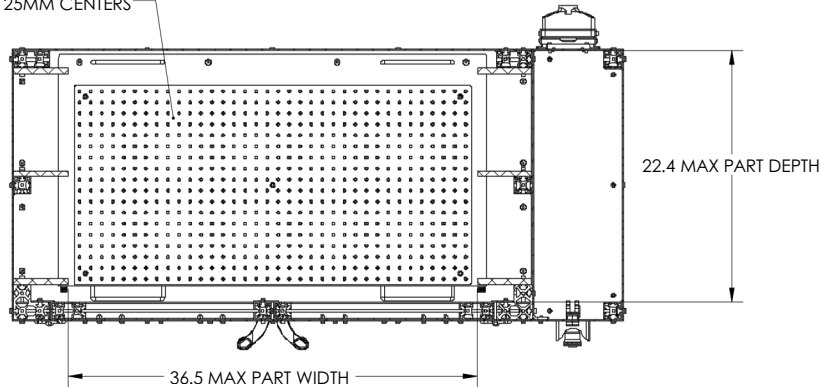

DIMENSIONS ARE GIVEN WITH GRID PLATE IN LOWEST POSITION ON ADJUSTABLE SHELF

NOTE LASER HAS 2 POSSIBLE MOUNTING POSITIONS USE CHART FOR X1 FOR POSITION 1 AND 2

Laser Model	X	Y	X1 Position 1	X1 Position 2	Y1	Z
STANDARD AREA MD-X2	125	125	150	450	218	421
WIDE AREA MD-X2	330	330	150	450	218	310
STANDARD AREA MD-U2	125	125	150	450	225	421
WIDE AREA MD-U2	330	330	150	450	225	310
STANDARD AREA ML-Z	120	120	150	450	218	421
WIDE AREA ML-Z	300	300	150	450	218	310
STANDARD AREA MD-F	125	125	150	450	225	442
WIDE AREA MD-F	300	300	150	450	225	321

NOTE: ADD 51MM TO ALL Z DIMENSIONS IF PLACING GRID PLATE DIRECTLY ON FLOOR OF ME-2x

ME-3_M Laser Marking Enclosure

\$19895.00

- Class 1 certified for use with KEYENCE lasers (ML-Z, MD-X2, MD-U2, and MD-F, both standard and wide area variants)
- Laser head is fix mounted inside of the enclosure
- Wired to a CAT 3 safety specification utilizing KEYENCE light curtain and door safety switches
- PC with Windows 11 Pro/monitor/keyboard/mouse on an articulating arm
- KeyView software application for HMI, axis control and seamless integration with the KEYENCE laser
- Manually adjustable Z shelf

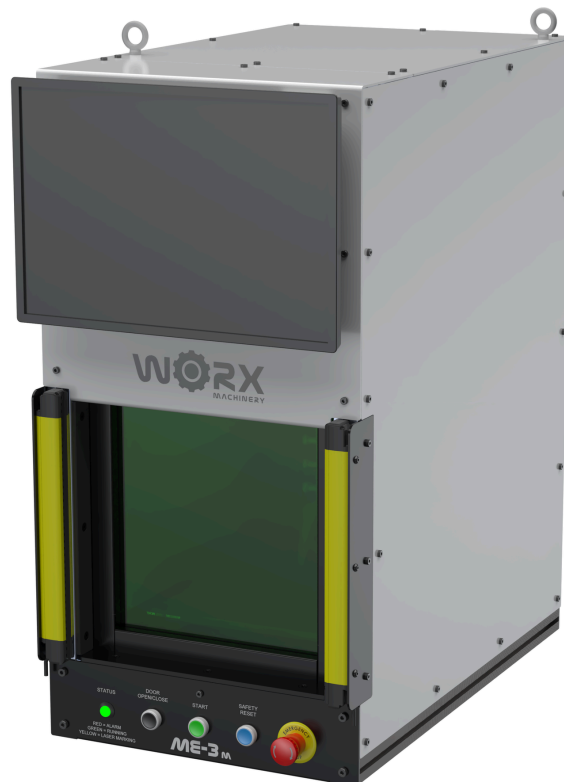

ME-3M Options

FA1MRA Fume Extractor \$3295.00

- 165 CFM
- HEPA Filtration @ 0.3 micron
- Relay Activated version for integration with our KeyView software



ME-3M Open Mobile Base \$7595.00

- Aluminum extrusion frame
- Leveling casters
- Bottom shelf for laser controller and fume extractor storage
- Electric lifting legs



Long Part Pass Through Hole Port \$2495.00

- Round nylon bristle pass through hole
- Must submit drawing of part to Worx for approval/record
- 2.5" OD max

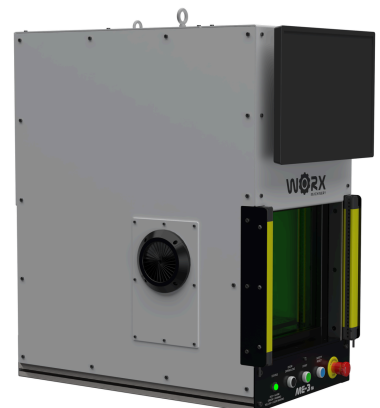

ME-3M Options

ME-3M Auto Z Shelf \$9295.00

- Programmable Z actuator with 150mm stroke (+/- 0.02mm repeatability)
- Tapped hole grid plate (M6x1mm tapped holes on 25mm centers)
- 20lb maximum lift capacity

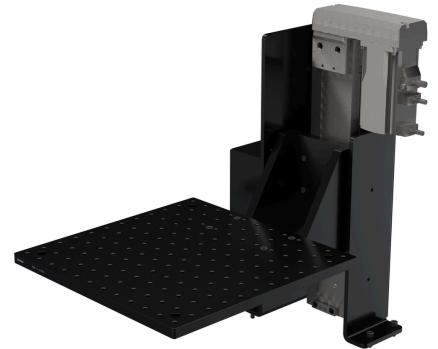

ME-3M Rotary Indexer Drill Chuck \$6895.00

- Closed loop stepper rotary indexer with battery-less encoder (+/- 0.004deg positional repeatability)
- 1/2" keyless drill chuck
- Minimum programmable increment of 1 degree, maximum 8 rotations



Barcode Reader Package \$3295.00

- KEYENCE handheld 1D/2D barcode reader
- Scan-to-program selection activated in KeyView



Fixturing Kit \$895.00

- 1 ea corner datum
- 2 ea vee blocks
- 4 ea round blocks
- 4 ea round eccentric blocks



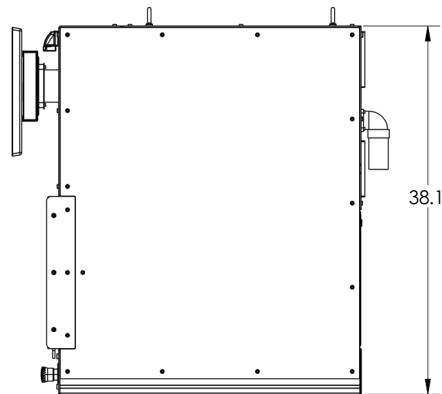
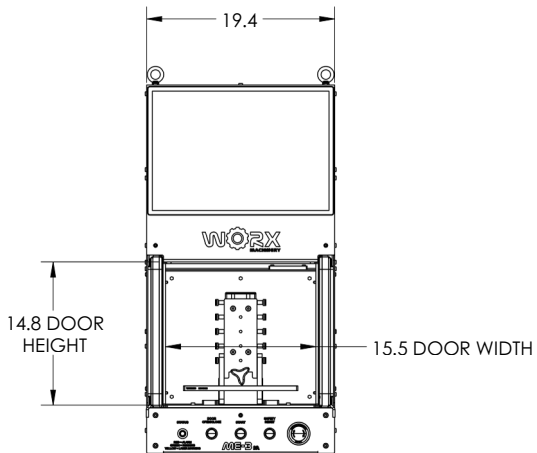
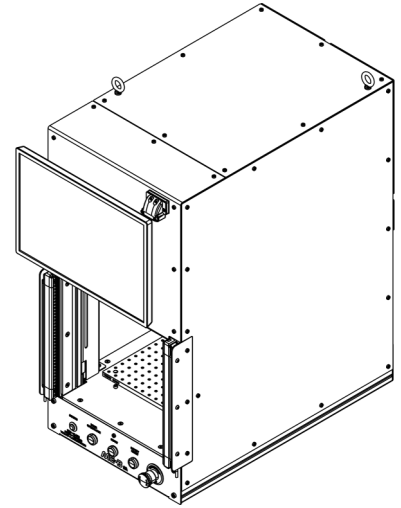
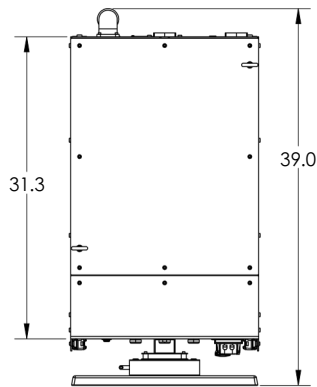

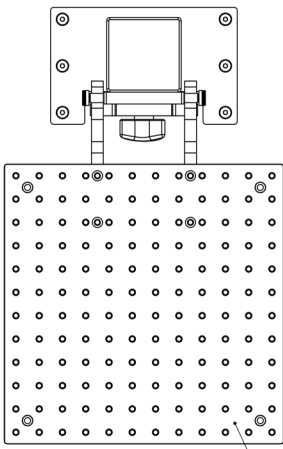

SHELF ADJUSTS IN 5X 1.5" INCREMENTS

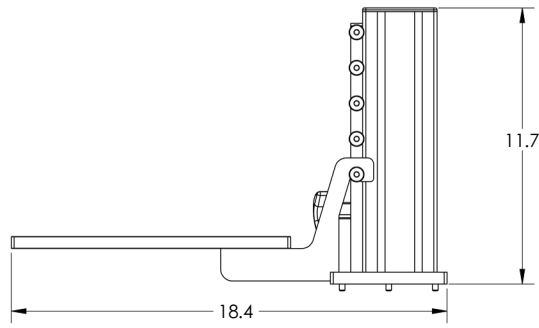
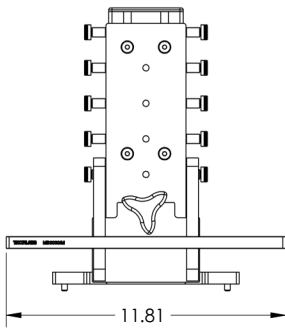
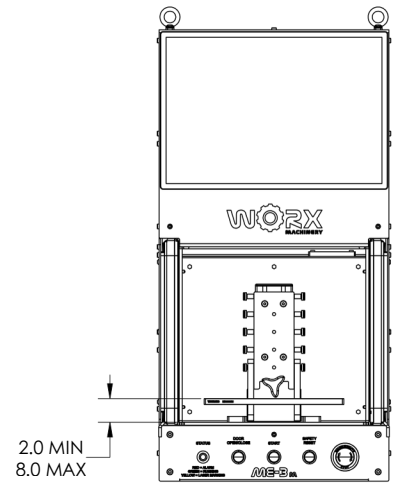
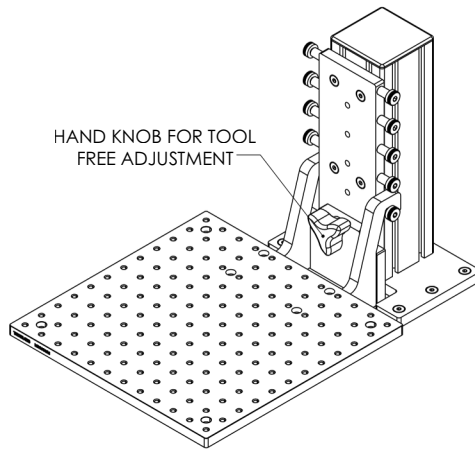

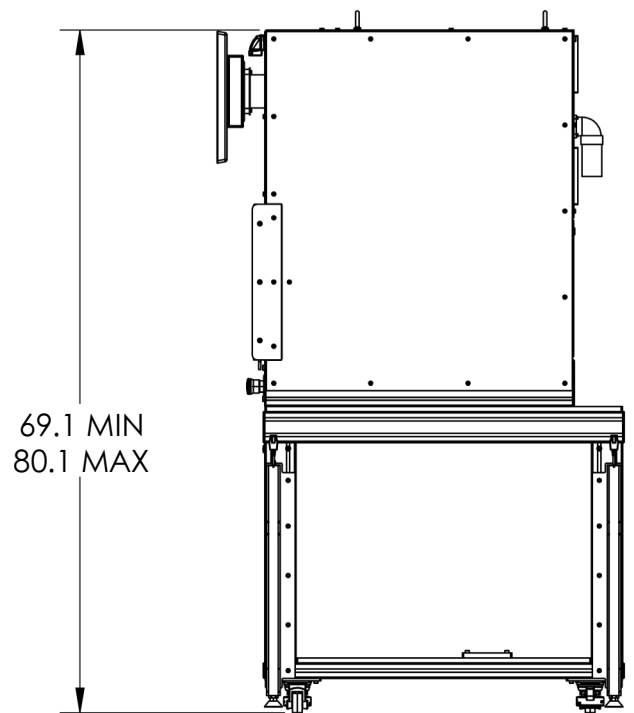
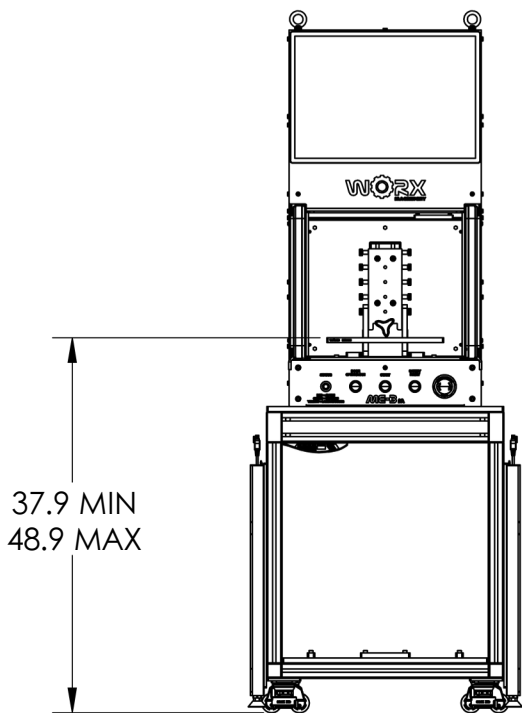
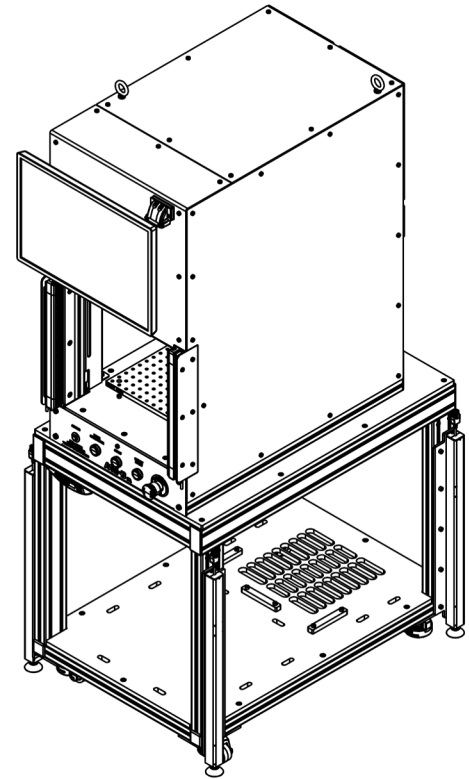
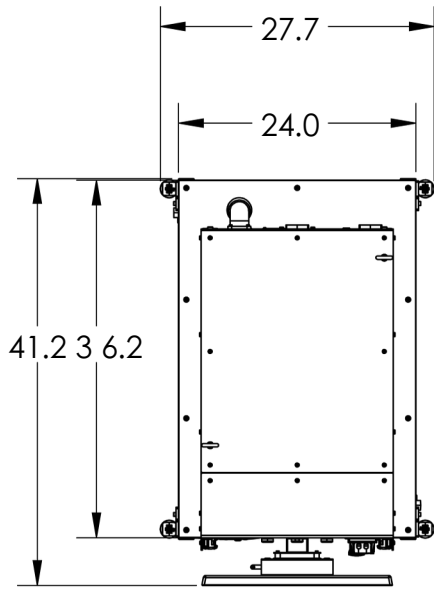

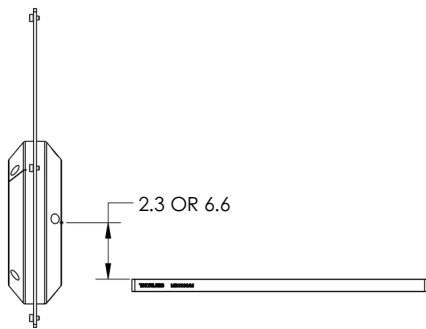
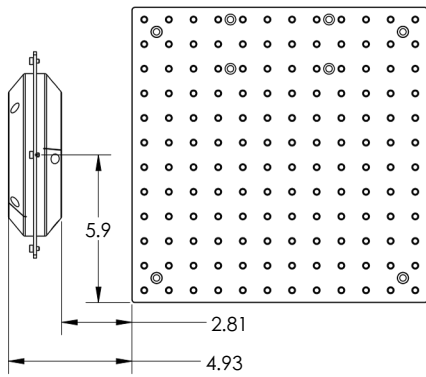

PASS THROUGH PANEL CAN BE FLIPPED TO PUT CENTER OF HOLE AT TWO DIFFERENT HEIGHTS

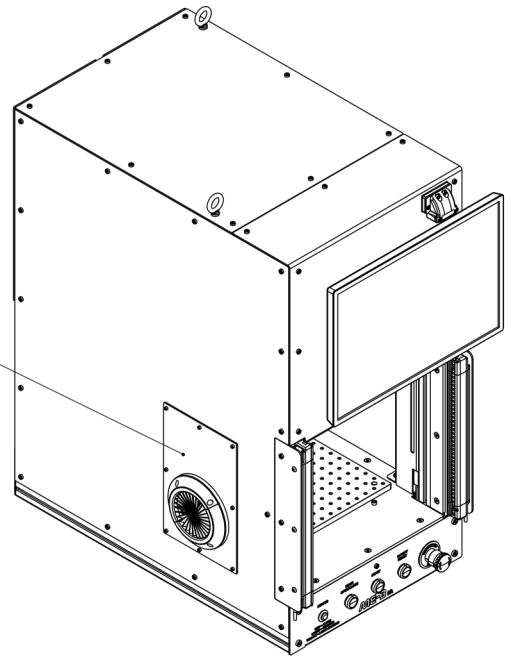

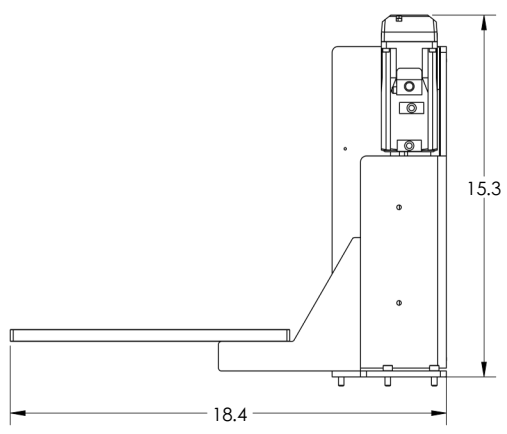
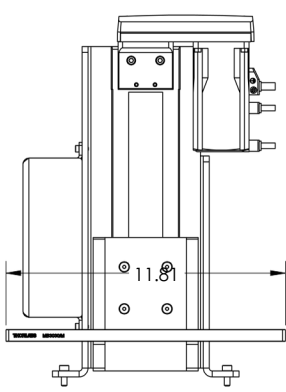
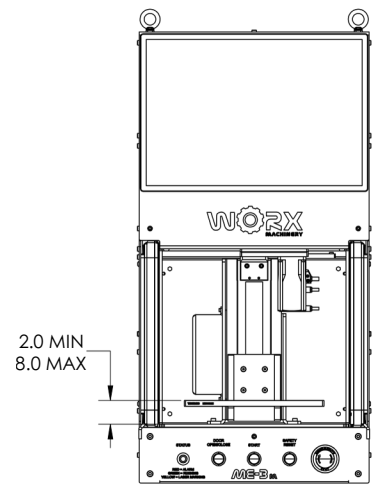
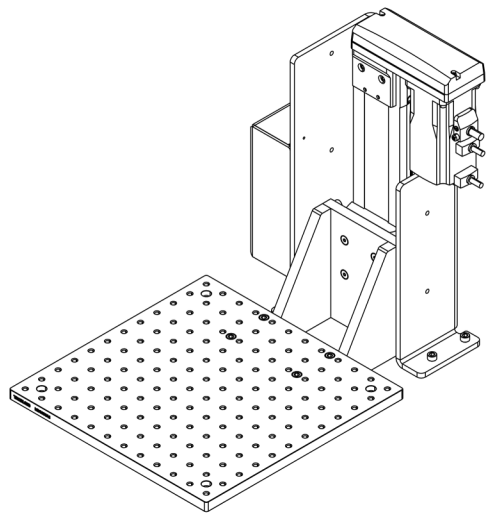
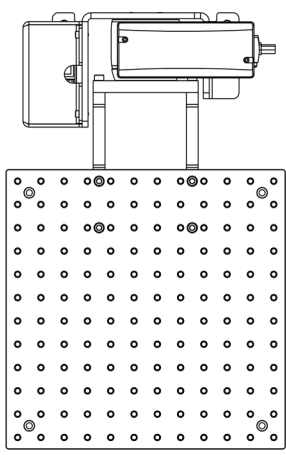

ME-3M Rotary Indexer Drill Chuck

Page 45

Dimensions

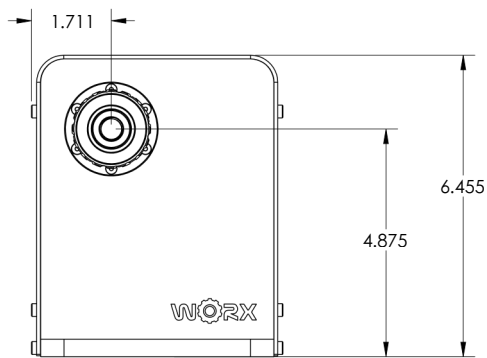
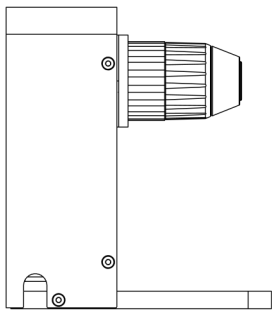
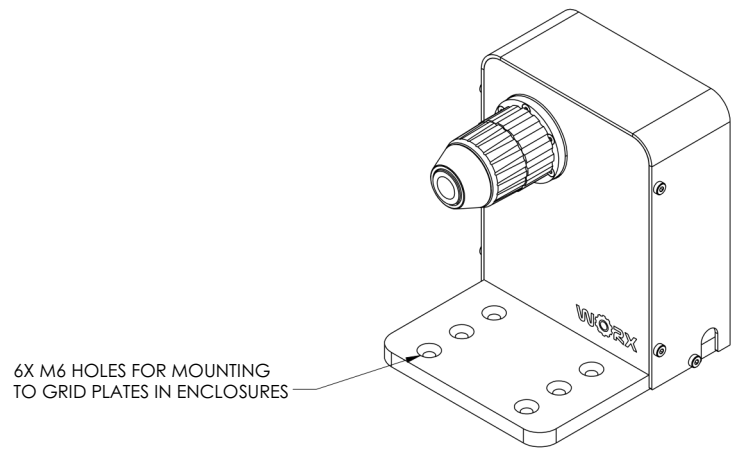
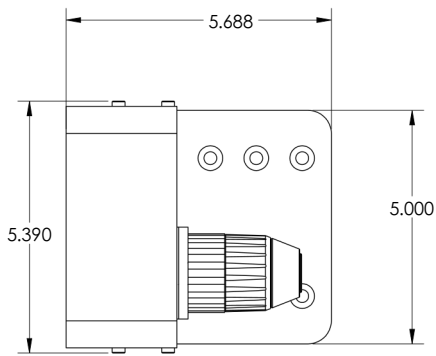

Laser Marking Area Dimensions (with manual Z shelf)

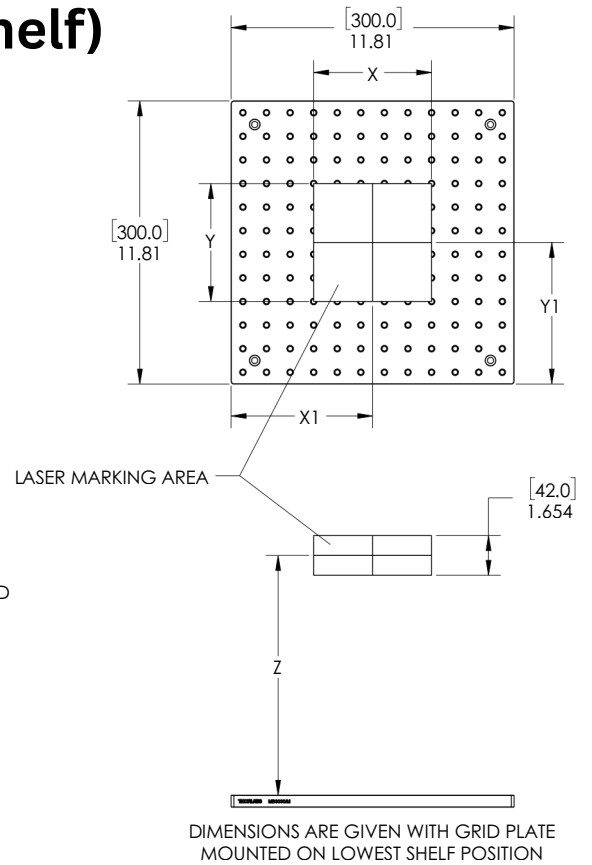
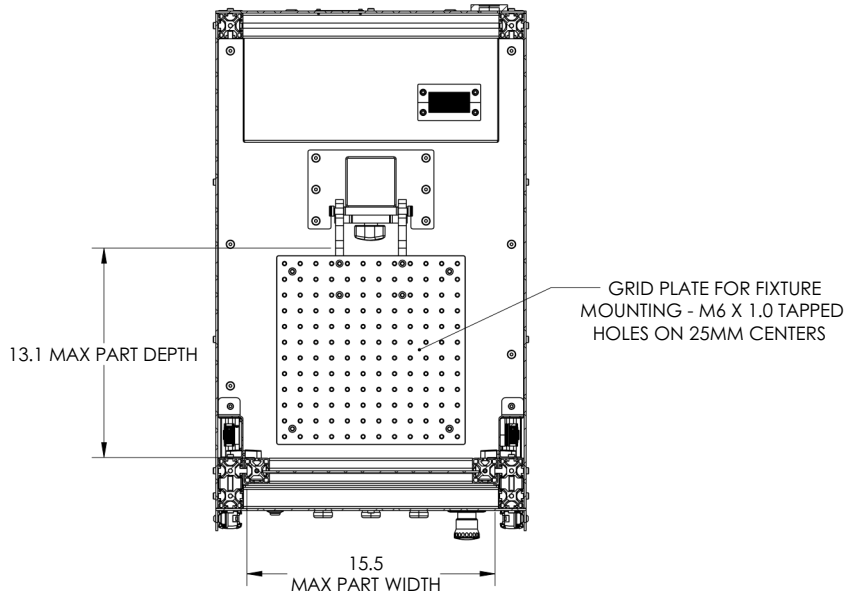

Laser Model	X	Y	X1	Y1	Z
STANDARD AREA MD-X2	125	125	157	150	168
WIDE AREA MD-X2	330	330	157	150	168
STANDARD AREA MD-U2	125	125	150	175	168
WIDE AREA MD-U2	330	330	150	175	168
STANDARD AREA ML-Z	120	120	157	150	168
WIDE AREA ML-Z	300	300	157	150	168
STANDARD AREA MD-F	125	125	150	150	189
WIDE AREA MD-F	300	300	150	150	168

**NOTE: ADD 38MM TO ALL Z DIMENSIONS IF
PLACING GRID PLATE DIRECTLY ON FLOOR OF ME-3M**

Laser Marking Area Dimensions (with Auto Z shelf)

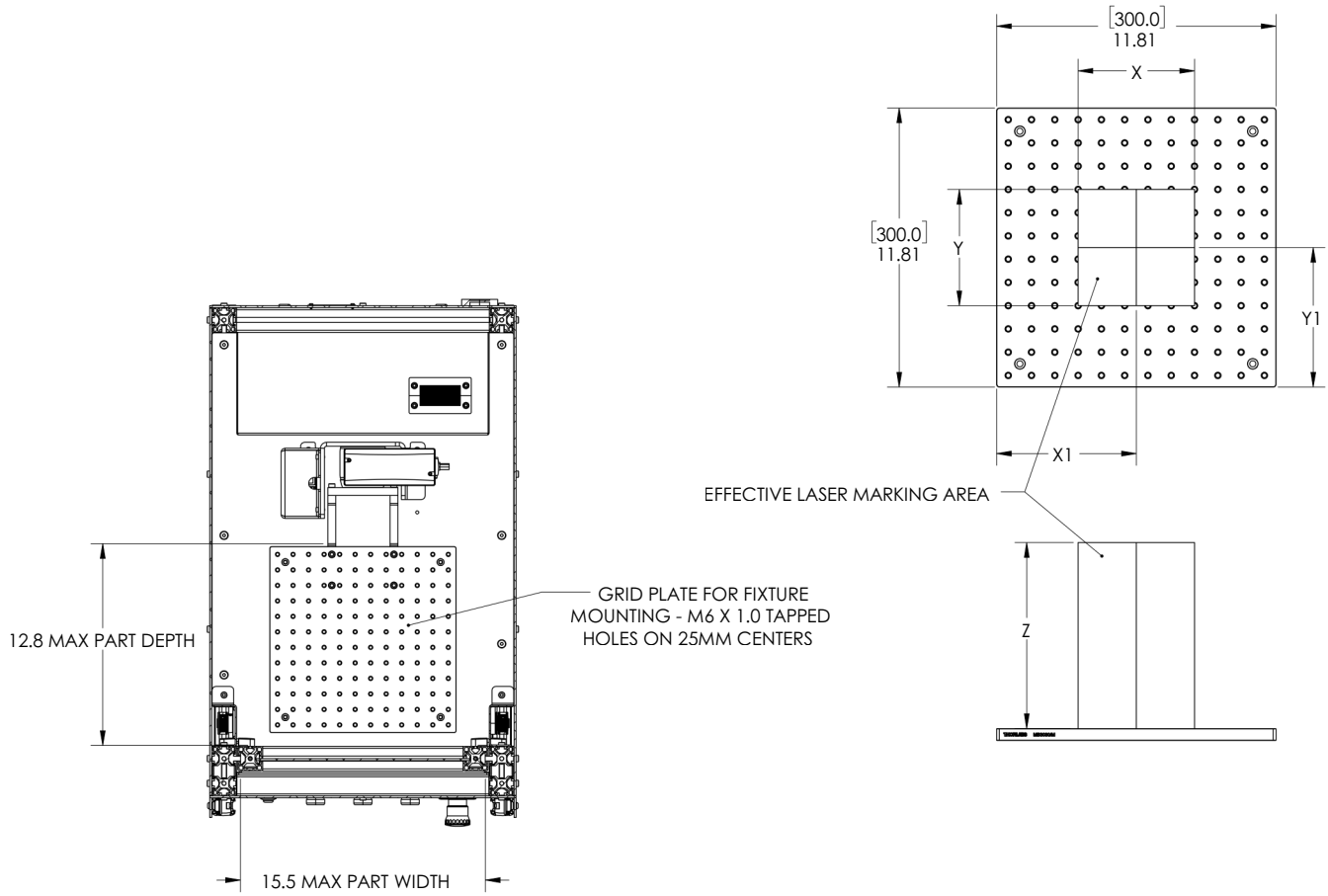

Laser Model	X	Y	X1	Y1	Z
STANDARD AREA MD-X2	125	125	157	150	189
WIDE AREA MD-X2	330	330	157	150	189
STANDARD AREA MD-U2	125	125	150	175	189
WIDE AREA MD-U2	330	330	150	175	189
STANDARD AREA ML-Z	120	120	157	150	189
WIDE AREA ML-Z	300	300	157	150	189
STANDARD AREA MD-F	125	125	150	150	210
WIDE AREA MD-F	300	300	150	150	189

ME-3 Laser Marking Enclosure

\$38895.00

- Class 1 certified for use with KEYENCE lasers (ML-Z, MD-X2, MD-U2, and MD-F, both standard and wide area variants)
- Laser head on programmable Z actuator with 200mm stroke (+/- 0.02mm repeatability)
- Wired to a CAT 3 safety specification utilizing KEYENCE light curtain, KEYENCE door safety switches, and a KEYENCE safety controller
- PC with Windows 11 Pro/monitor/keyboard/mouse on an articulating arm
- KeyView software application for HMI, axis control and seamless integration with the KEYENCE laser

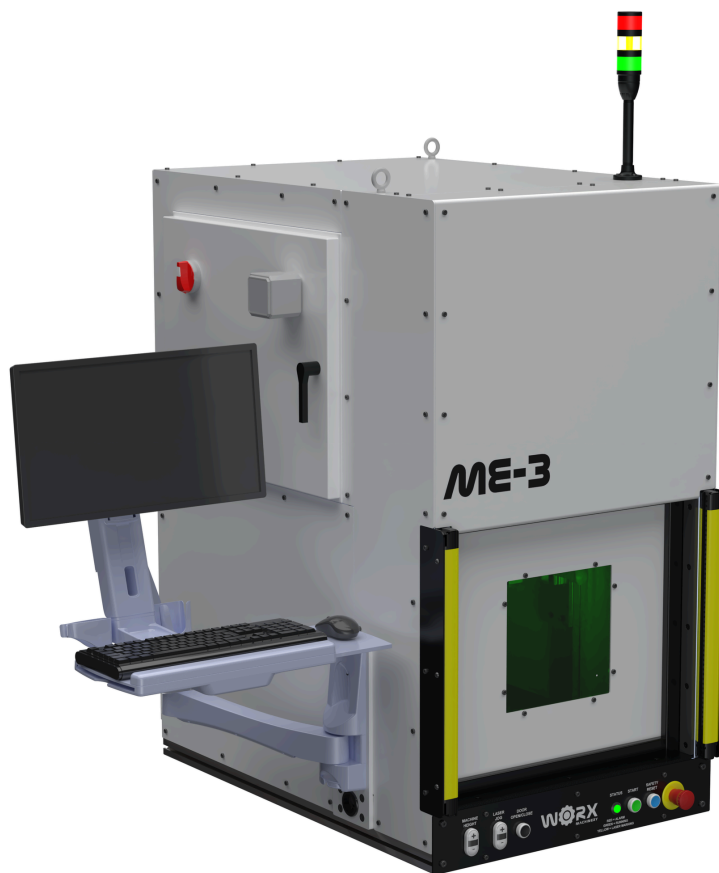

ME-3 Options

FA1MRA Fume Extractor \$3295.00

- 165 CFM
- HEPA Filtration @ 0.3 micron
- Relay Activated version for integration with our KeyView software



ME-3 Mobile Base With Height Adjustment \$8295.00

- Enclosed mobile base with leveling caster
- Built in lifting mechanism to put work surface 32.7" to 42.7" from the floor



Rotary Indexer 3 Jawed Chuck

\$9895.00

ME-3/ME-3_{MAX} Only

- Closed loop stepper rotary indexer with battery-less encoder (+/- 0.004deg positional repeatability)
- 3 jawed lathe chuck (2mm-70mm OD grip, 24mm-64mm ID grip)
- Minimum programmable increment of 1 degree, maximum 8 rotations



ME-3 Options

Pneumatic 5c Collet Closer Upgrade Package For Precision Rotary Indexer \$5995.00

- Pneumatic 5c collet closer (no collet supplied)
- Manual hand operated valve
- Filter/regulator for compressed air connection

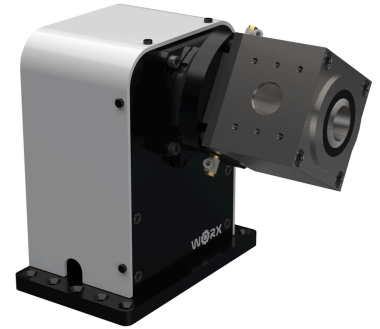

Long Part Pass Through \$2495.00

- Round nylon bristle pass through hole
- Must submit drawing of part to Worx for approval/record
- 2.5" OD max
- Right side only

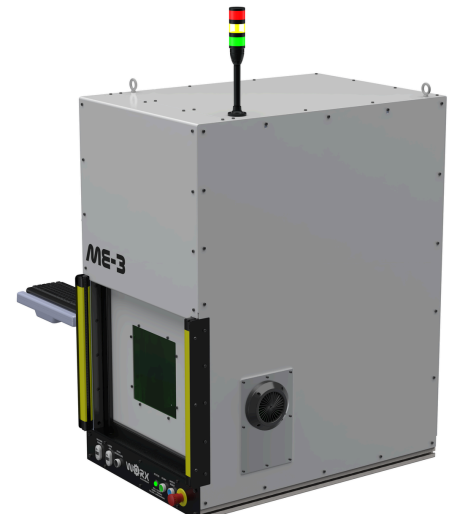

ME-3 Slide Out Work Surface \$7895.00

- Heavy duty slide out work surface with tapped hole grid plate (M6x1 tapped holes on 25mm centers)
- Electromagnet and monitored sensors to hold the shelf in place while marking
- Maximum load - 100lbs

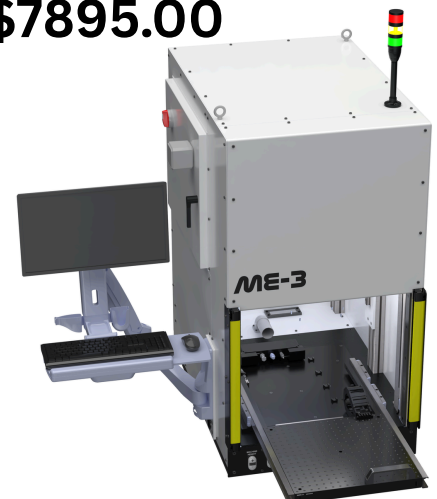

ME-3 Options

Barcode Reader Package \$3295.00

- KEYENCE handheld 1D/2D barcode reader
- Scan-to-program selection activated in KeyView



Fixturing Kit \$895.00

- 1 ea corner datum
- 2 ea vee blocks
- 4 ea round blocks
- 4 ea round eccentric blocks



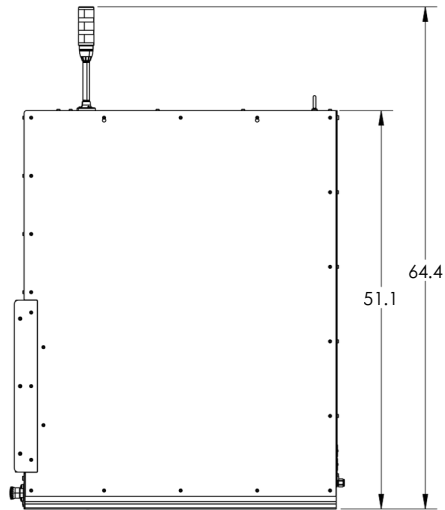
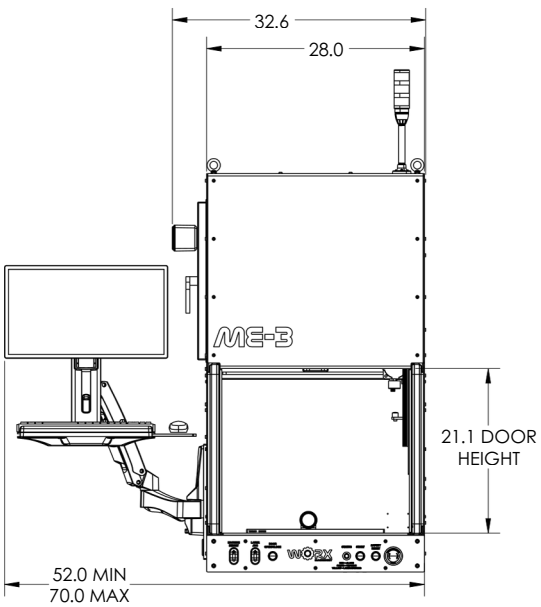
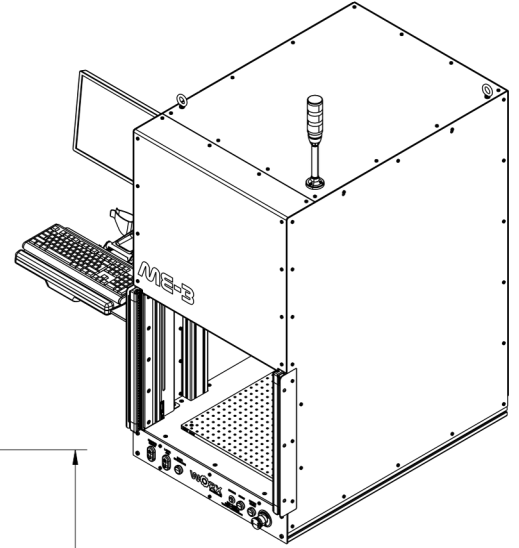
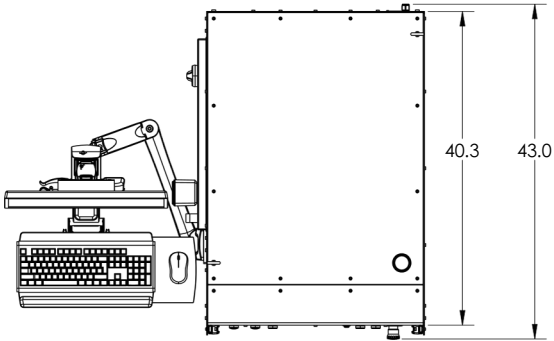

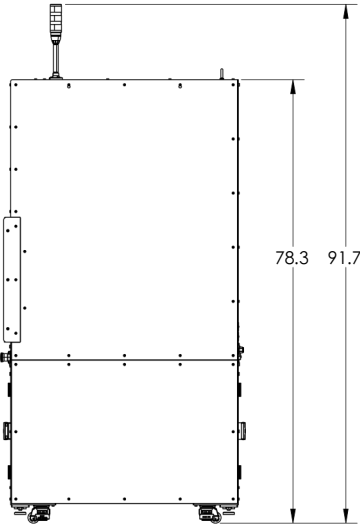
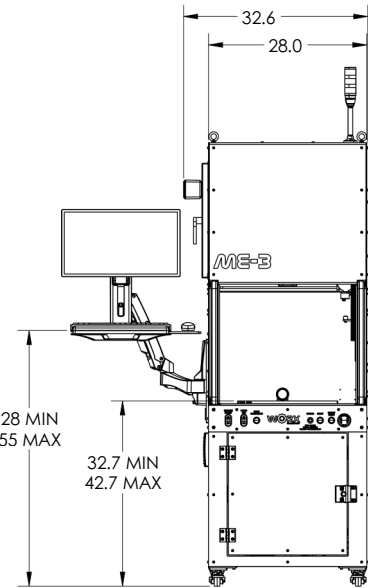
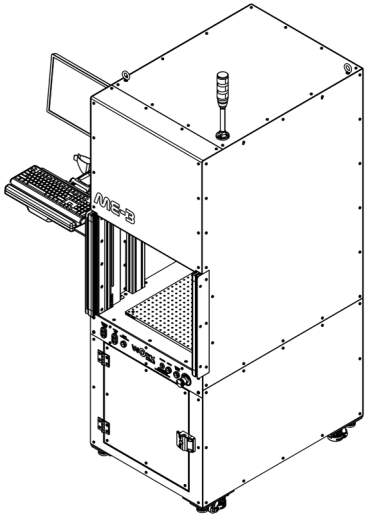
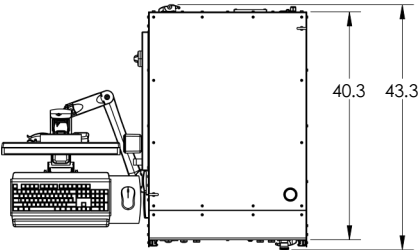

ME-3 Rotary Indexer 3 Jawed Chuck Dimensions

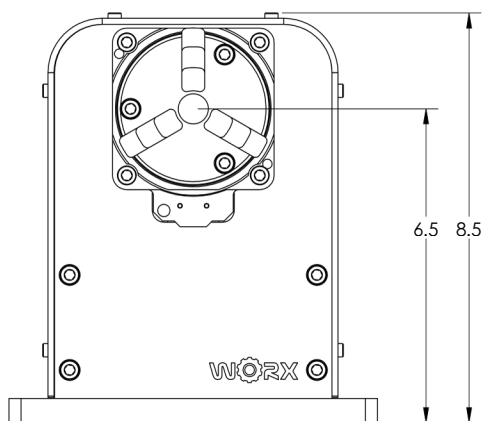
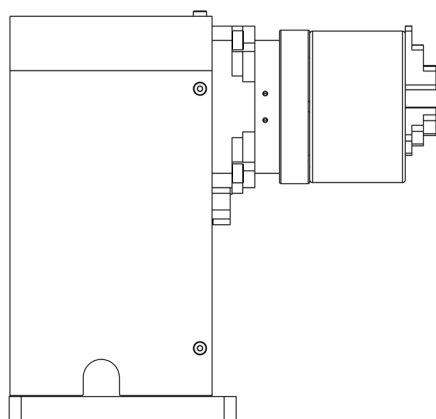
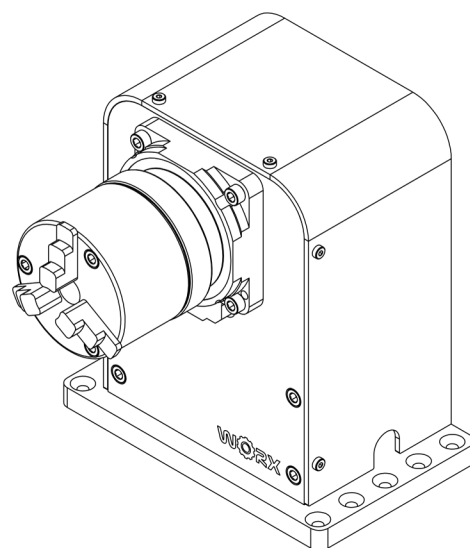
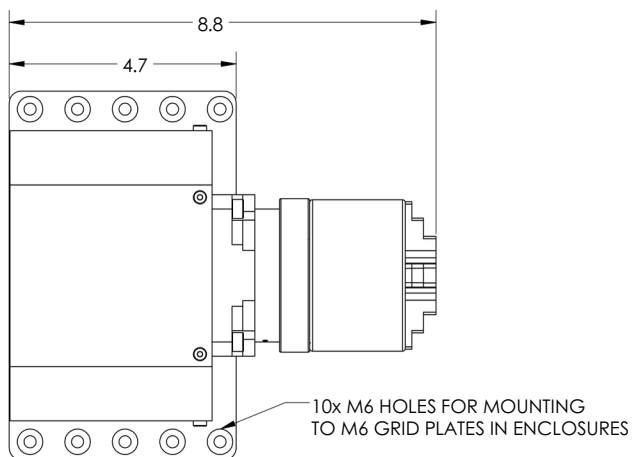

ME-3 Rotary Indexer 5c Collet Closer Dimensions

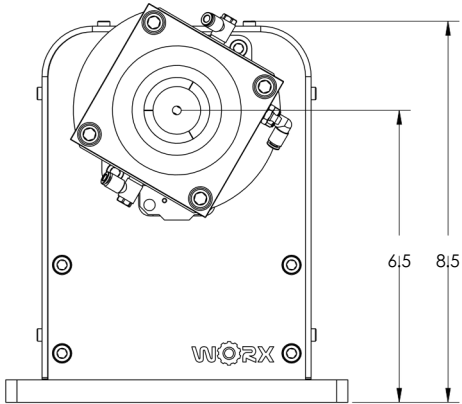
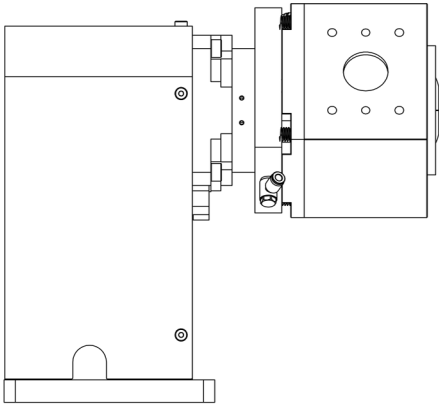
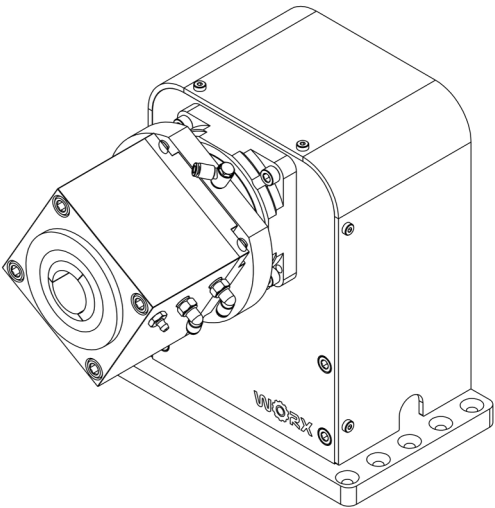
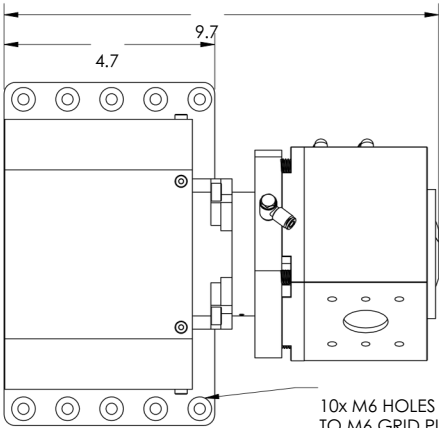

ME-3 Long Part Pass Through Dimensions Page 56

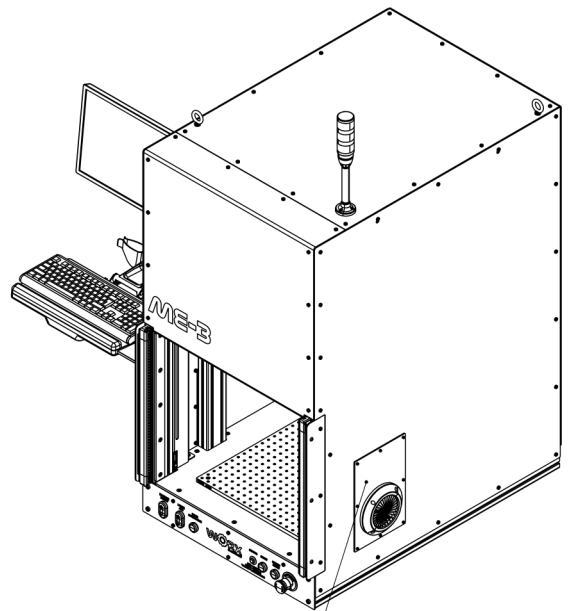
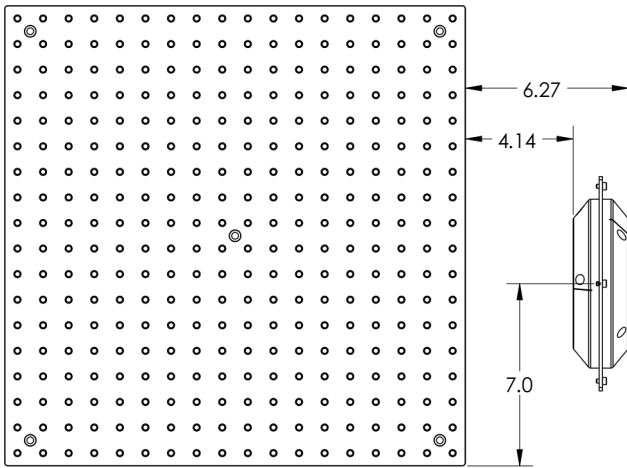

PASS THROUGH PANEL CAN BE
FLIPPED TO PUT CENTER OF
HOLE AT TWO DIFFERENT
HEIGHTS

ME-3 Slide Out Shelf Dimensions Page 57

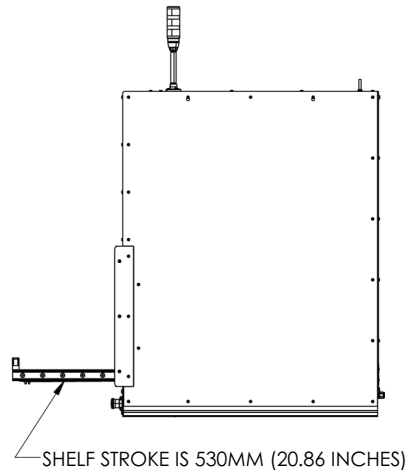
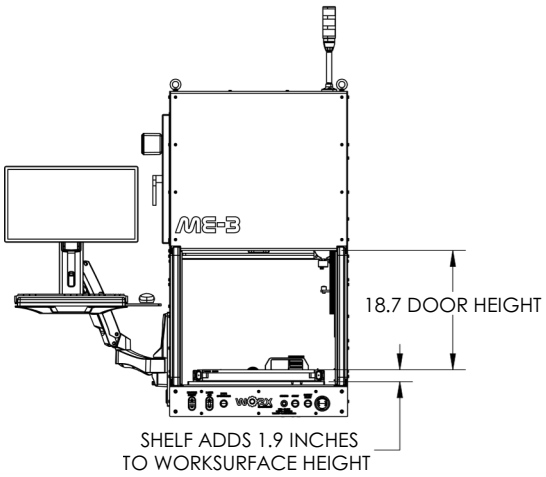
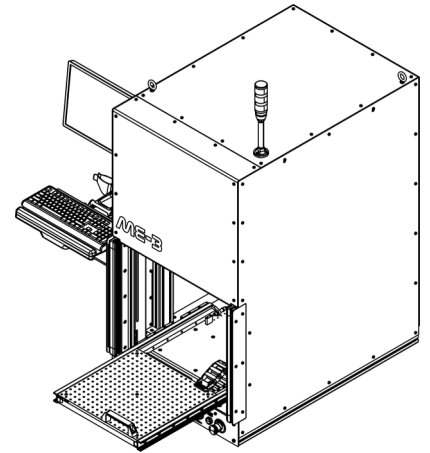
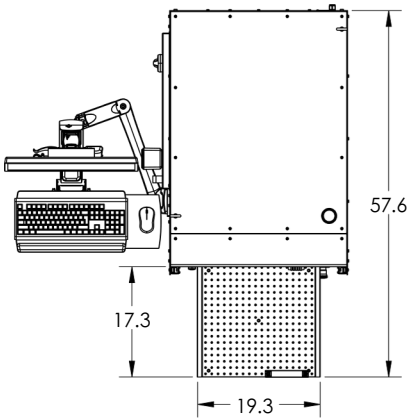

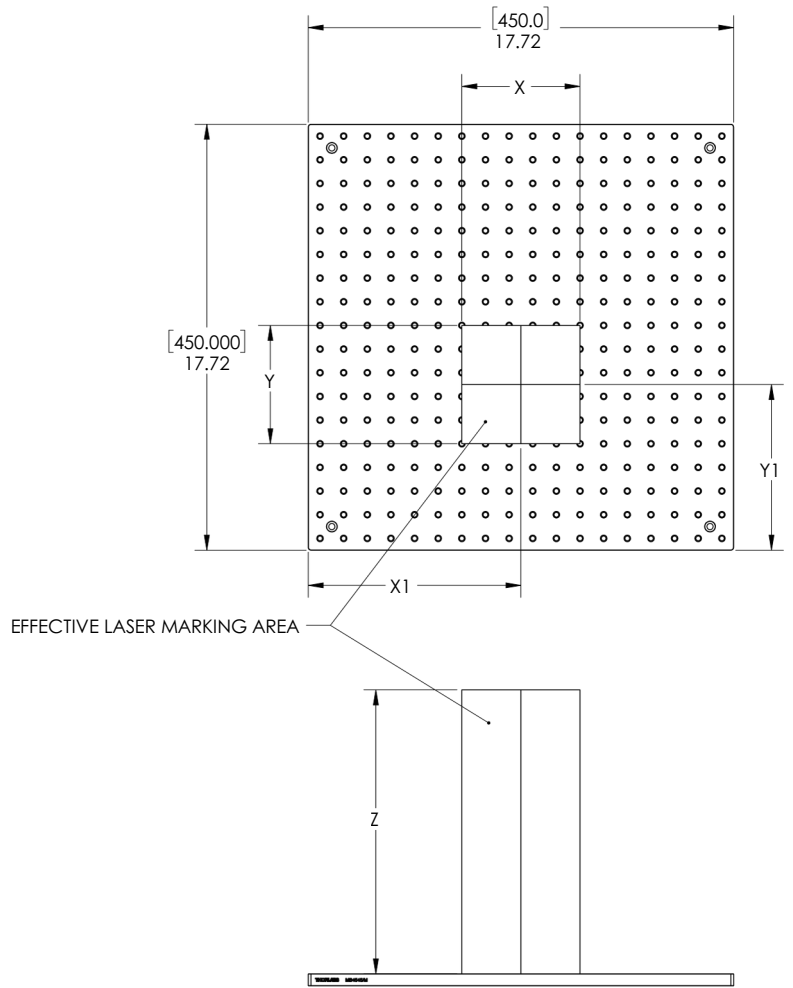
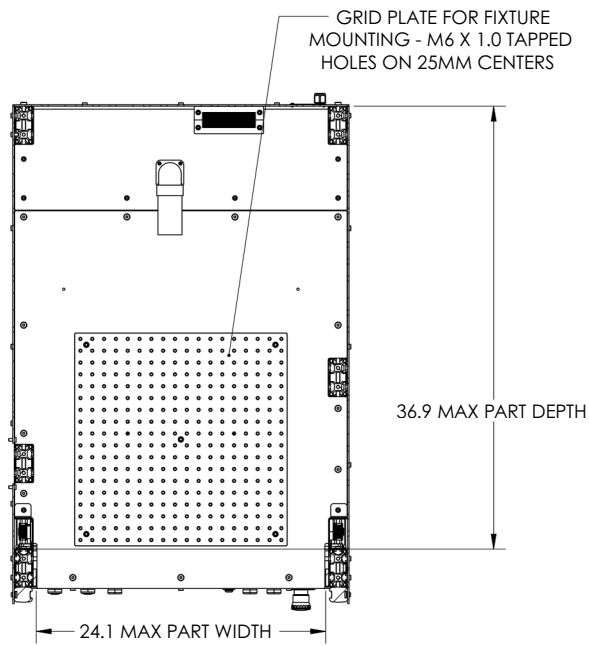

Laser Model	X	Y	X1	Y1	Z
STANDARD AREA MD-X2	125	125	232	175	420
WIDE AREA MD-X2	330	330	232	175	420
STANDARD AREA MD-U2	125	125	225	185	370
WIDE AREA MD-U2	330	330	225	185	370
STANDARD AREA ML-Z	120	120	232	175	420
WIDE AREA ML-Z	300	300	232	175	420
STANDARD AREA MD-F	125	125	225	175	441
WIDE AREA MD-F	300	300	225	175	420

ME-3_R Laser Marking Enclosure

\$69495.00

- Class 1 certified for use with KEYENCE lasers (ML-Z, MD-X2, MD-U2, and MD-F, both standard and wide area variants)
- Laser head on programmable Z axis (250mm stroke, +/- 0.02mm repeatability)
- 2 position dial table (+/- 0.004deg positional repeatability)
- Built in lifting mechanism to put work surface 32.7" to 42.7" from the floor
- Wired to a CAT 3 safety specification utilizing KEYENCE light curtain, KEYENCE door safety switches. and a KEYENCE safety controller
- PC with Windows 11 Pro/monitor/keyboard/mouse on an articulating arm
- KeyView software application for HMI, axis control seamless integration with the KEYENCE laser



ME-3_R Options

FA1MRA Fume Extractor \$3295.00

- 165 CFM
- HEPA Filtration @ 0.3 micron
- Relay Activated version for integration with our KeyView software



Barcode Reader Package \$3295.00

- Keyence handheld 1D/2D barcode reader
- Scan-to-program selection activated in KeyView



Fixturing Kit \$895.00

- 1 ea corner datum
- 2 ea vee blocks
- 4 ea round blocks
- 4 ea round eccentric blocks



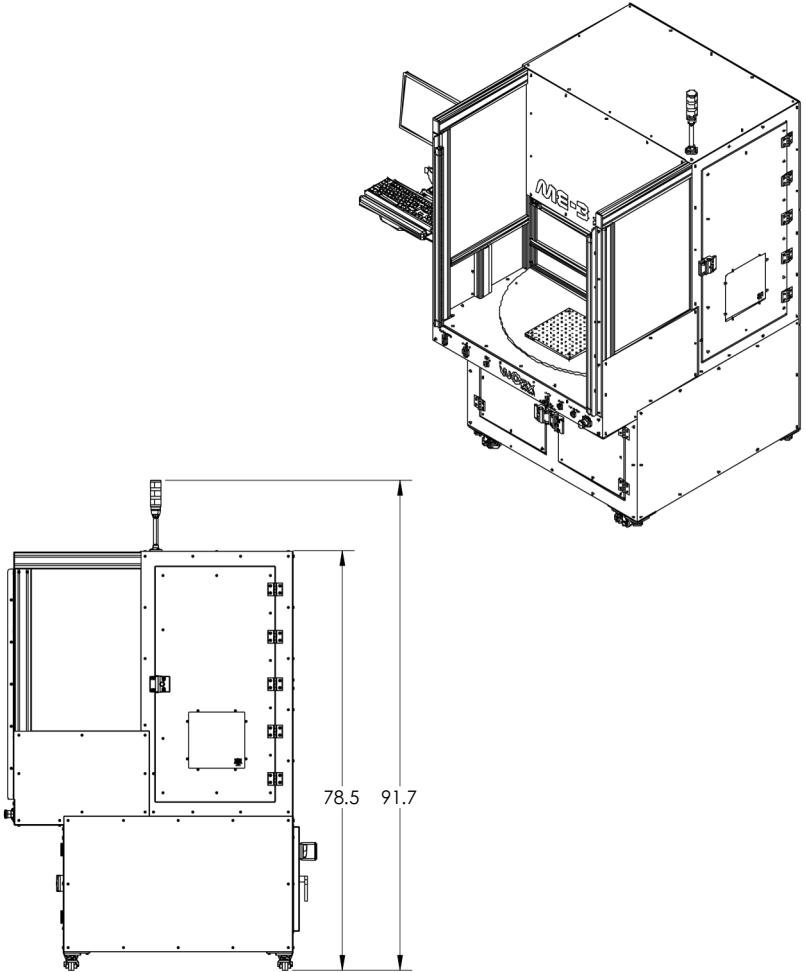
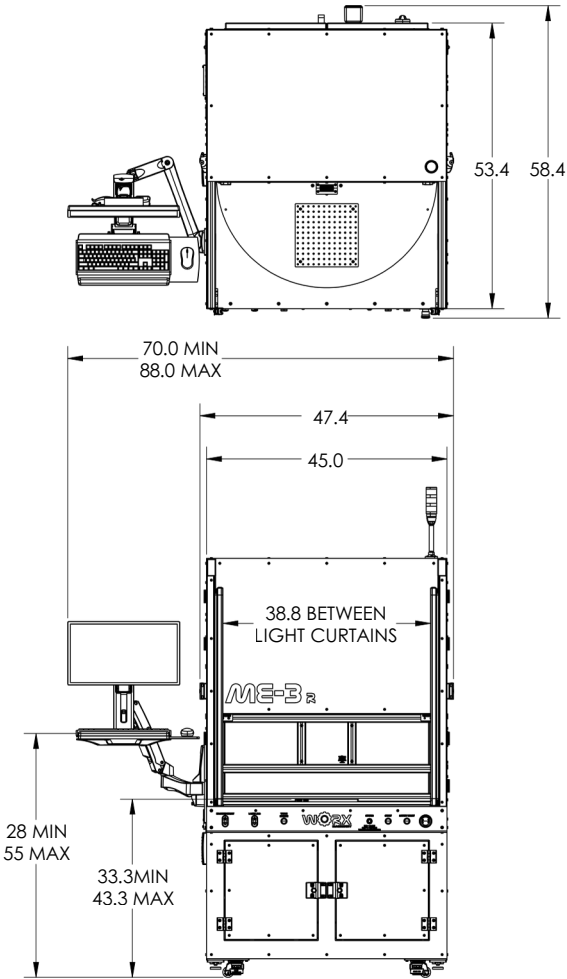

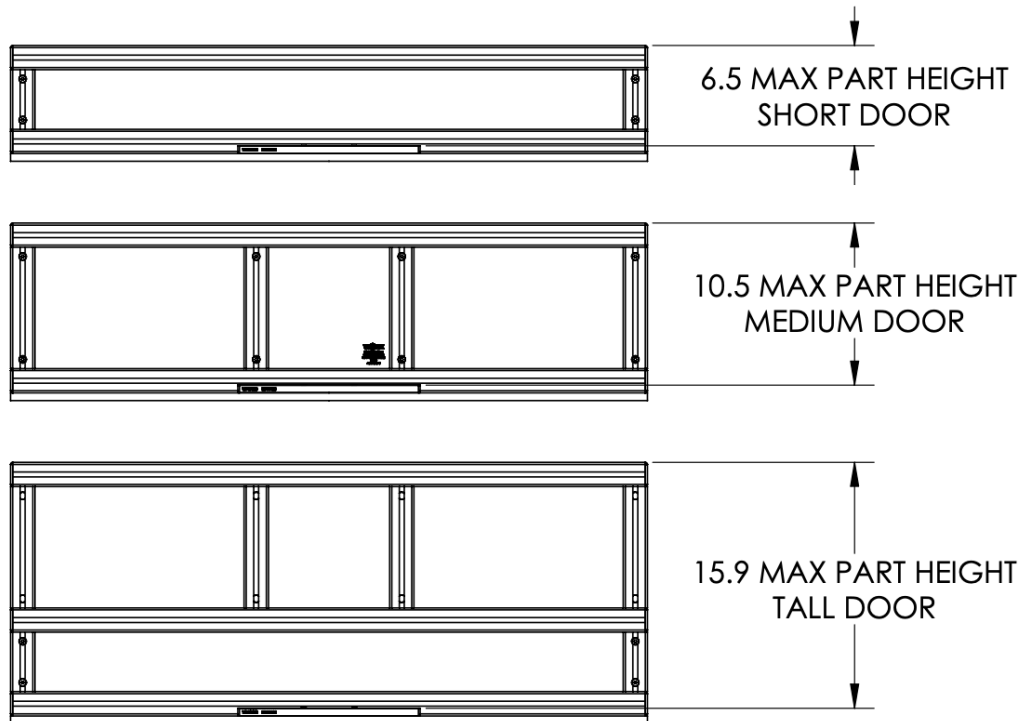
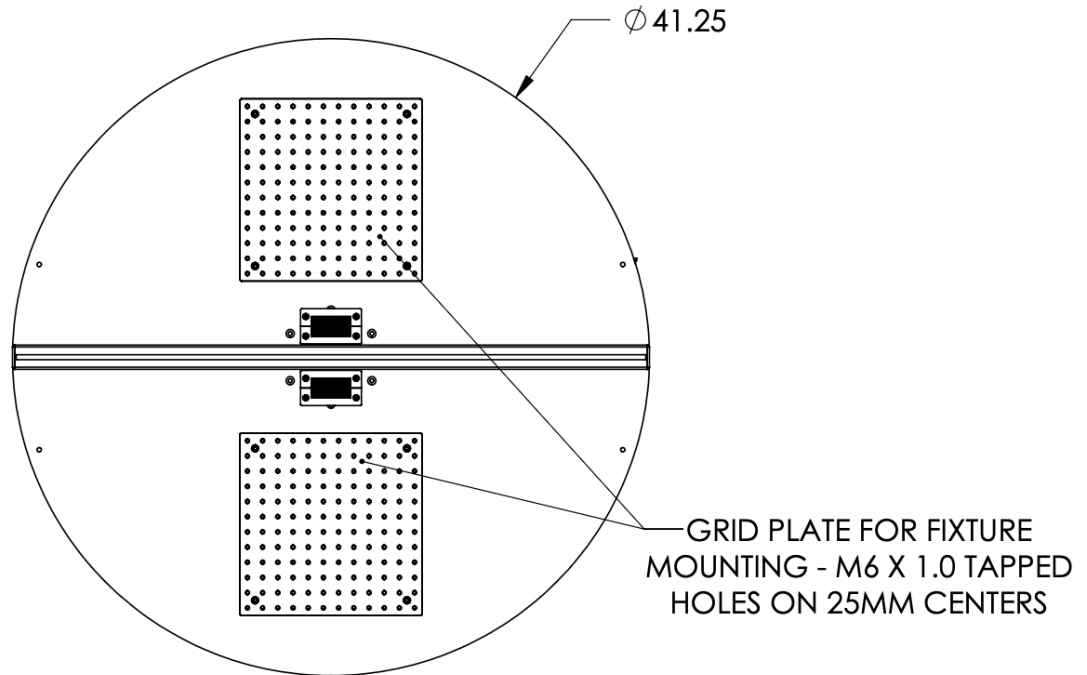

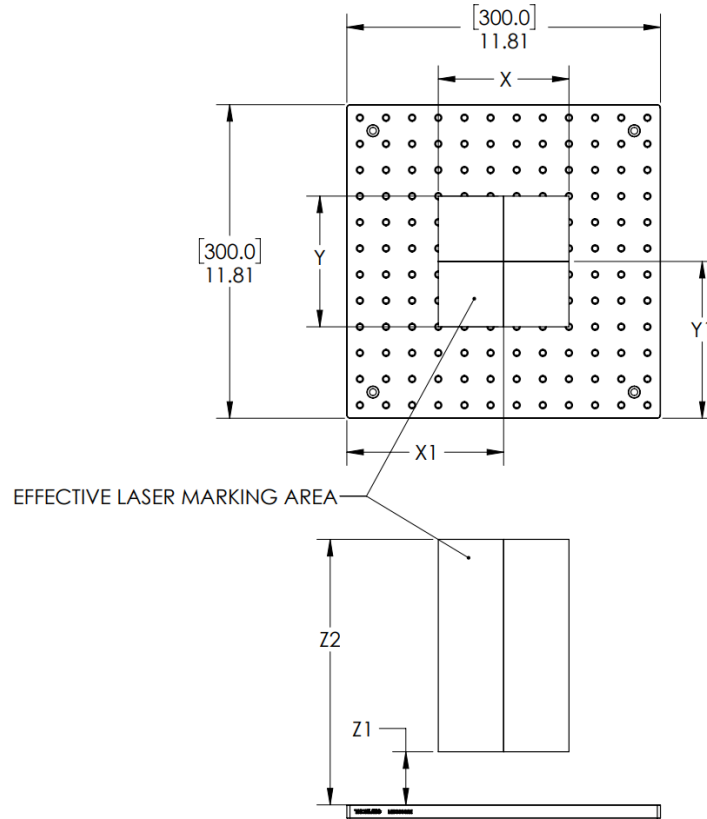

Laser Model	X	Y	X1	Y1	Z1 Low Door	Z2 Low Door	Z1 Mid Door	Z2 Mid Door	Z1 High Door	Z2 High Door
STANDARD AREA MD-X2	125	125	150	157	0	165	74	266	214	403
WIDE AREA MD-X2	330	330	150	157	N/A	N/A	0	266	103	403
STANDARD AREA MD-U2	125	125	150	150	0	165	74	266	214	372
WIDE AREA MD-U2	330	330	150	150	N/A	N/A	0	266	103	372
STANDARD AREA ML-Z	120	120	150	157	0	165	74	266	214	403
WIDE AREA ML-Z	300	300	150	157	N/A	N/A	0	266	103	403
STANDARD AREA MD-F	125	125	150	150	0	165	95	266	235	403
WIDE AREA MD-F	300	300	150	150	N/A	N/A	0	266	103	403

ME-3_{MAX} Laser Marking Enclosure

\$83295.00

- Class 1 certified for use with the KEYENCE lasers (ML-Z, MD-X2, MD-U2, and MD-F, both standard and wide area variants)
- Laser head on programmable XYZ gantry (X=500mm, Y=350mm, Z=400mm +/- 0.02mm repeatability all axis)
- Built in lifting mechanism to put work surface 32.7" to 42.7" from the floor
- Wired to a CAT 3 safety specification utilizing KEYENCE light curtain, KEYENCE door safety switches and a KEYENCE safety controller
- PC with Windows 11 Pro/monitor/keyboard/mouse on an articulating arm
- KeyView software application for HMI, axis control and seamless integration with the KEYENCE laser



ME-3_{MAX} Options

FA1MRA Fume Extractor \$3295.00

- 165 CFM
- HEPA Filtration @ 0.3 micron
- Relay Activated version for integration with our KeyView software



Rotary Indexer 3 Jawed Chuck \$9895.00

ME-3/ME-3_{MAX} ONLY

- Closed loop stepper rotary indexer with battery-less encoder (+/- 0.004deg positional repeatability)
- 3 jawed lathe chuck (2mm-70mm OD grip, 24mm-64mm ID grip)
- Minimum programmable increment of 1 degree, maximum 8 rotations



Pneumatic 5c Collet Closer Upgrade Package For Precision Rotary Indexer \$5995.00

- Pneumatic 5c collet closer (no collet supplied)
- Manual hand operated valve
- Filter/regulator for compressed air connection

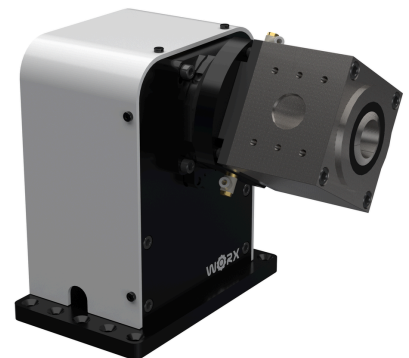

ME-3_{MAX} Options

Long Part Pass Through \$2495.00

- Round nylon bristle pass through hole
- Must submit drawing of part to Worx for approval/record
- 2.5" OD max
- Left side only



ME-3_{MAX} Slide Out Work Surface \$9895.00

- Heavy duty slide out work surface with tapped hole grid plate (M6x1 tapped holes on 25mm centers)
- Electromagnet and monitored sensors to hold the shelf in place while marking
- Maximum load - 200lbs

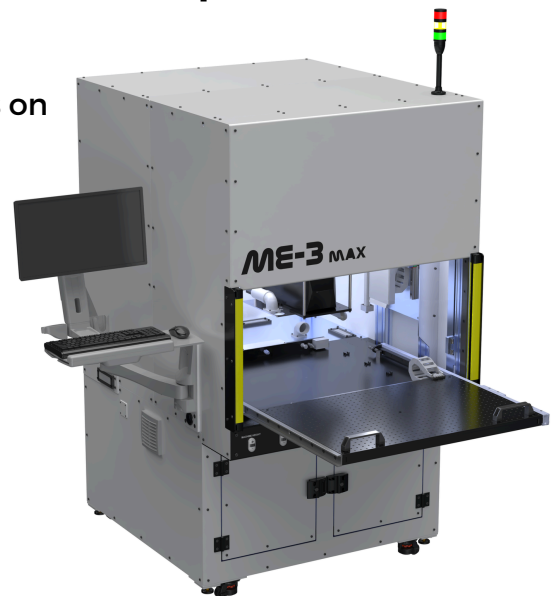

ME-3_{MAX} Options

Barcode Reader Package \$3295.00

- KEYENCE handheld 1D/2D barcode reader
- Scan-to-program selection activated in KeyView



Fixturing Kit \$895.00

- 1 ea corner datum
- 2 ea vee blocks
- 4 ea round blocks
- 4 ea round eccentric blocks



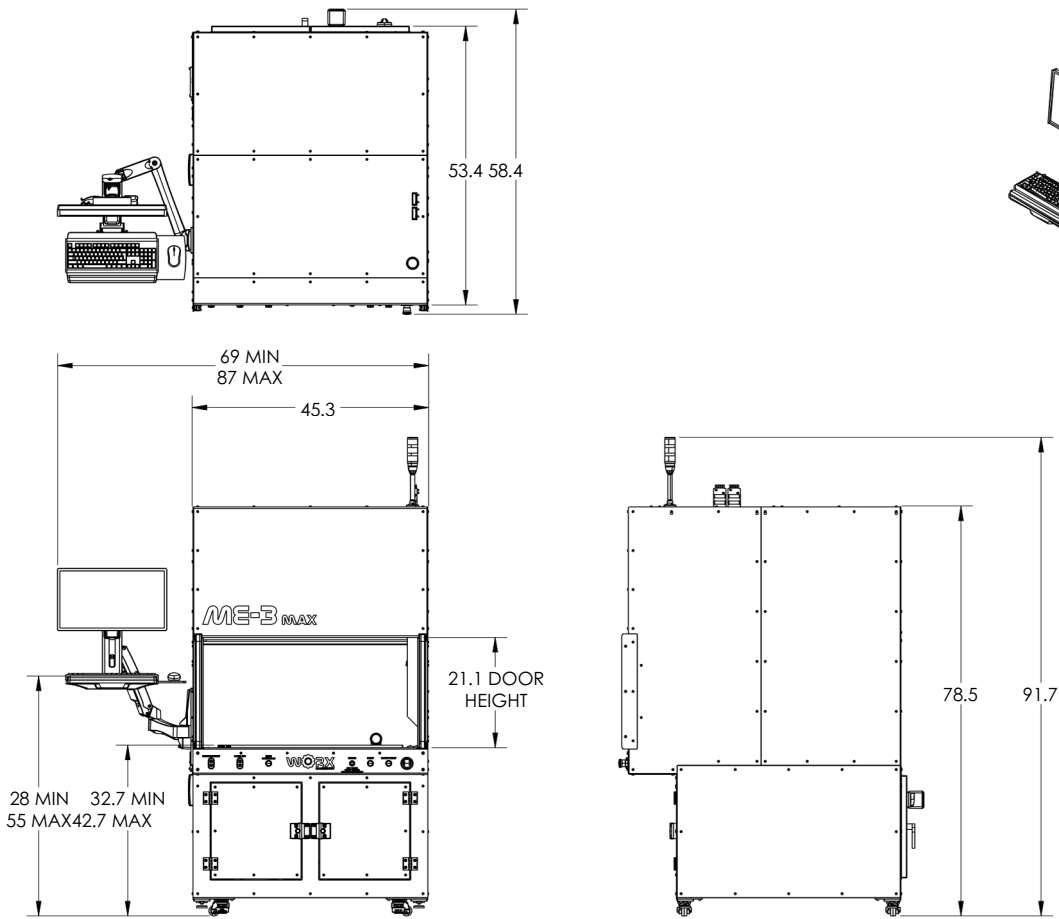

ME-3_{MAX} Rotary Indexer 3 Jawed Chuck Dimensions

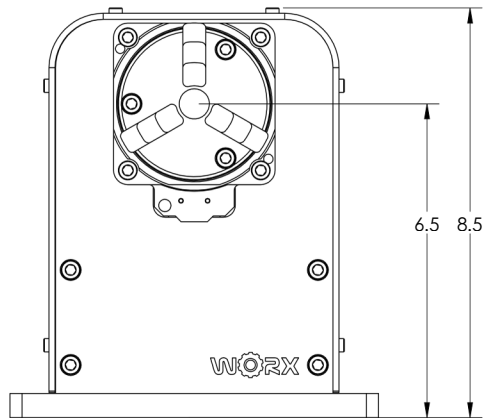
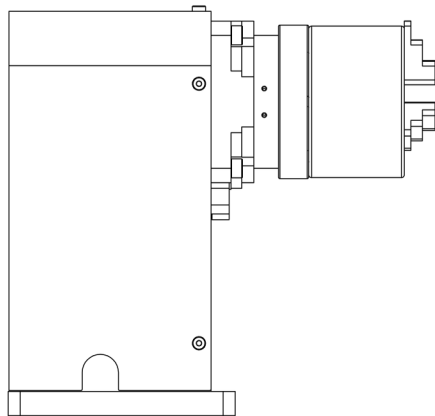
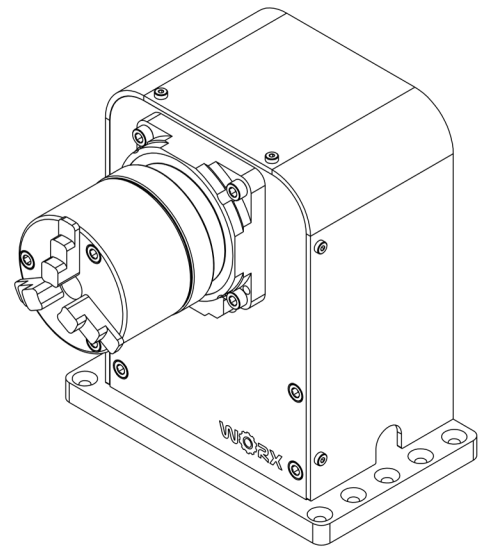
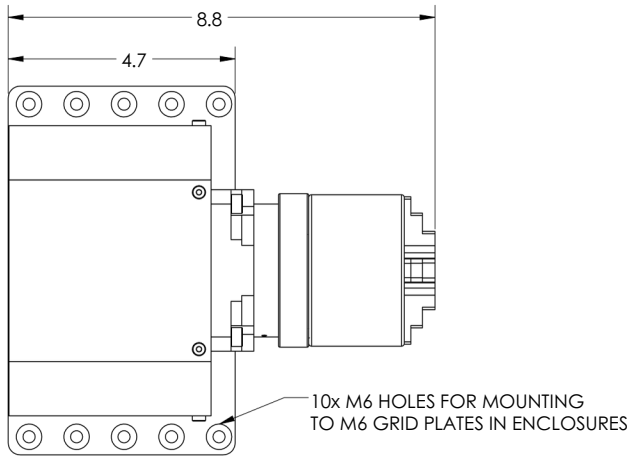

ME-3_{MAX} Rotary Indexer 5c Collet Closer Page 70

Dimensions

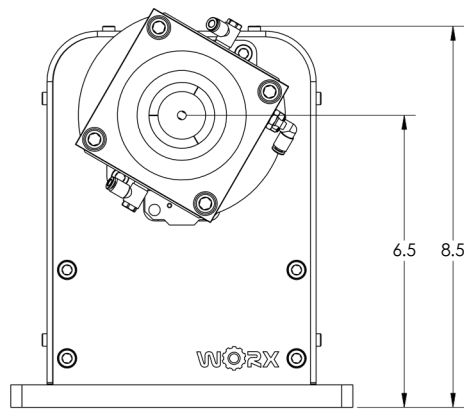
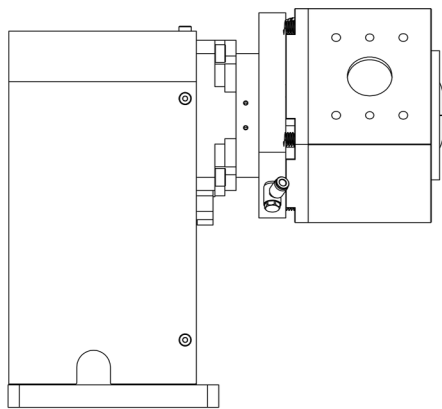
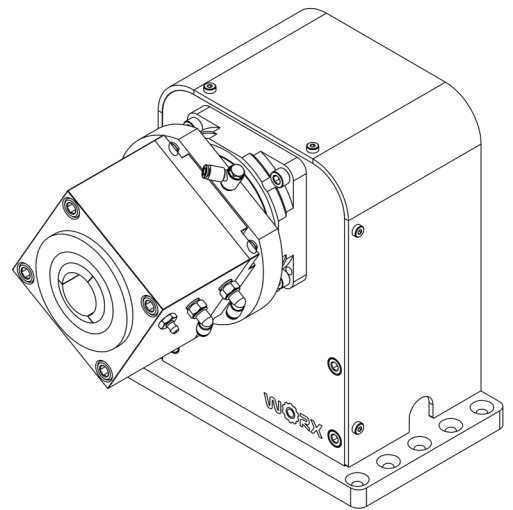
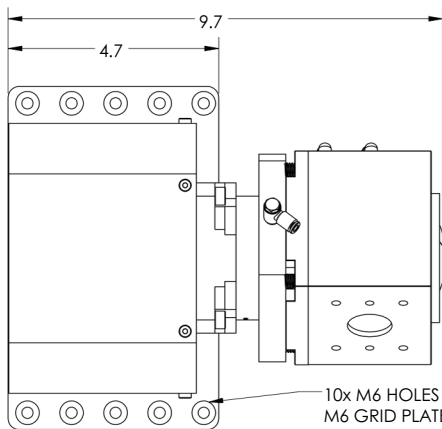

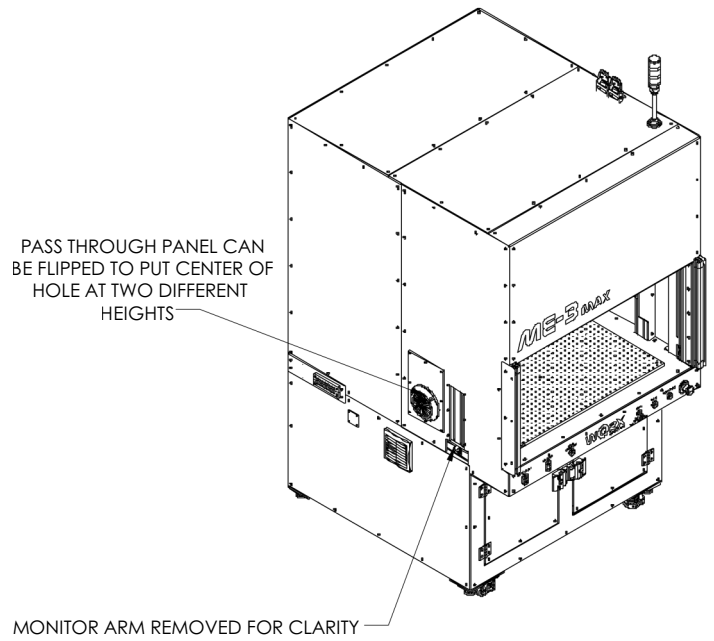
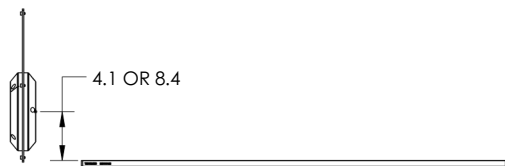
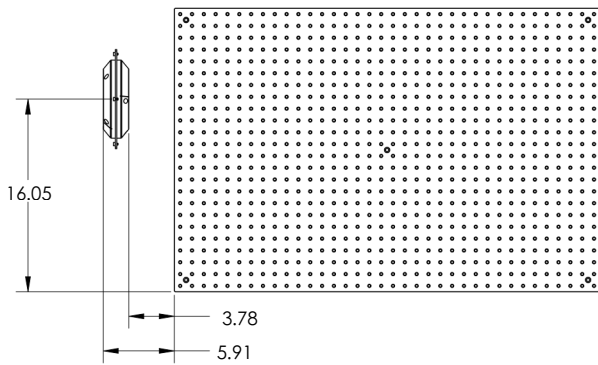

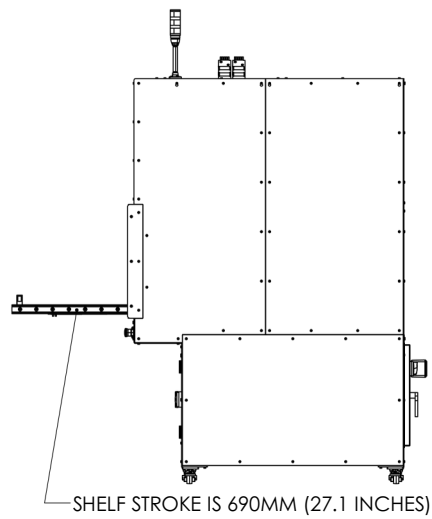
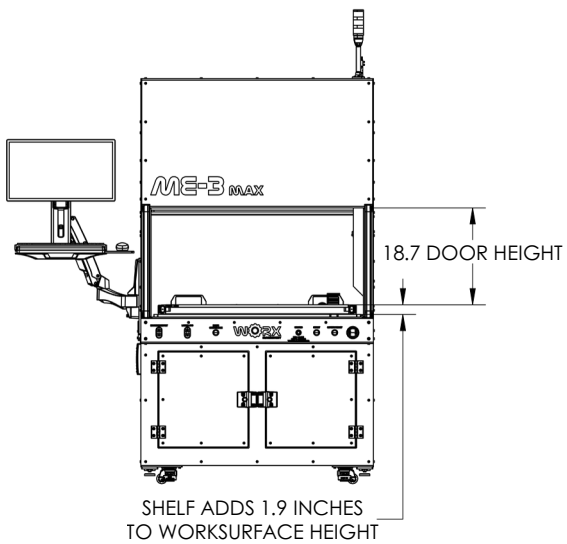
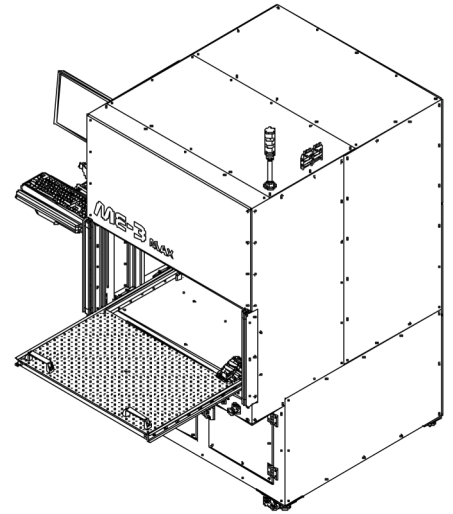
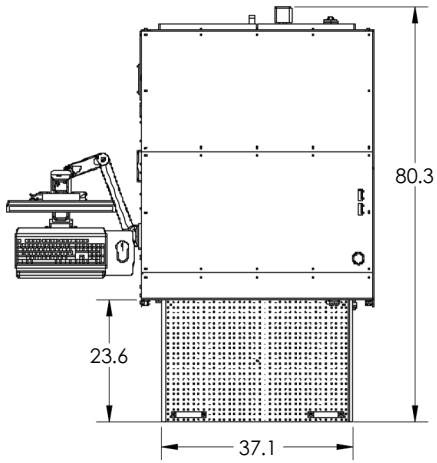

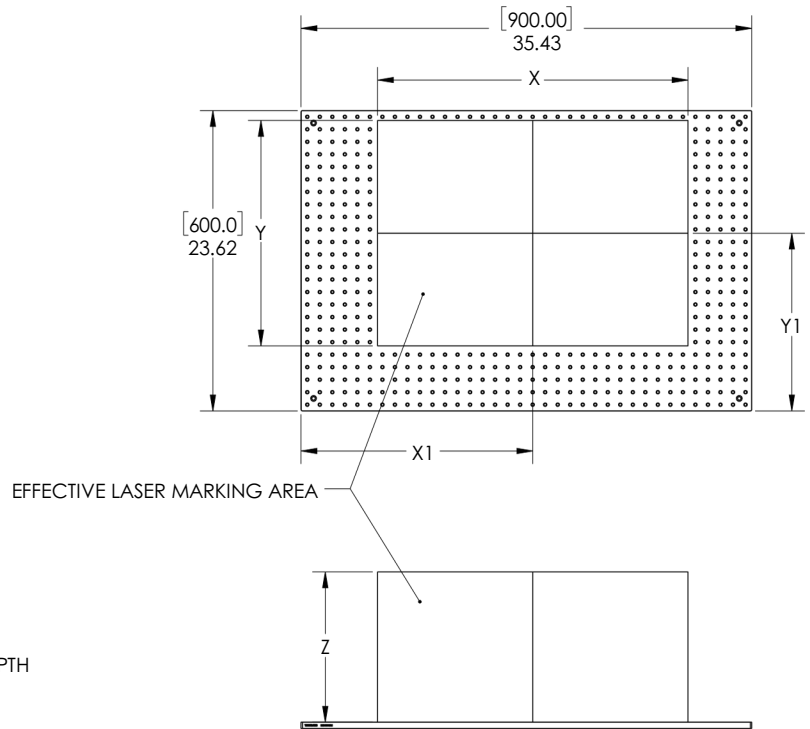
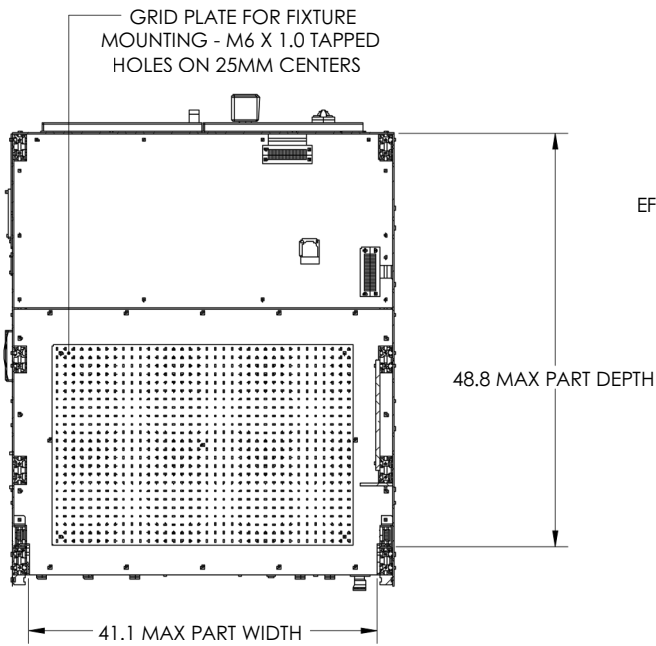

Laser Model	X	Y	X1	Y1	Z
STANDARD AREA MD-X2	625	475	474	355	420
WIDE AREA MD-X2	830	680	474	355	420
STANDARD AREA MD-U2	625	475	467	365	370
WIDE AREA MD-U2	830	680	467	365	370
STANDARD AREA ML-Z	620	470	474	355	420
WIDE AREA ML-Z	800	650	474	355	420
STANDARD AREA MD-F	625	475	467	355	441
WIDE AREA MD-F	800	650	467	355	420

CONTACT US



678-878-6772



john_hanks@worxmachinery.com



worxmachinery.com



4960 Marsett PKWY
Suite B
Cumming GA, 30041

